

Recycling Bot



Smart Education. Explore CLIL by using Robotics

2018-1-DE03-KA229-047198-6

PARTE 1

(the base)

1

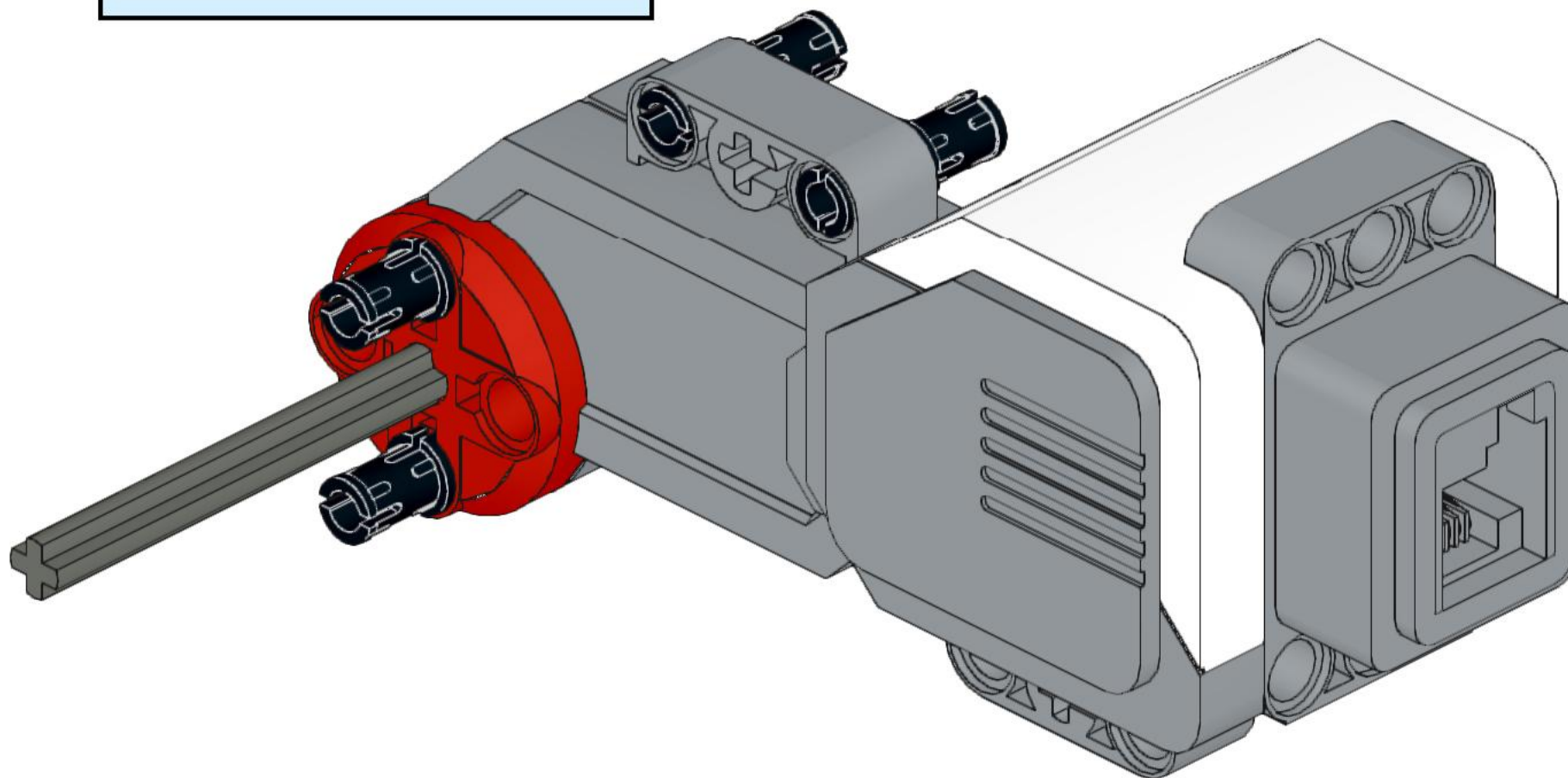
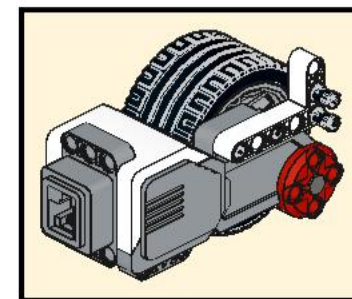
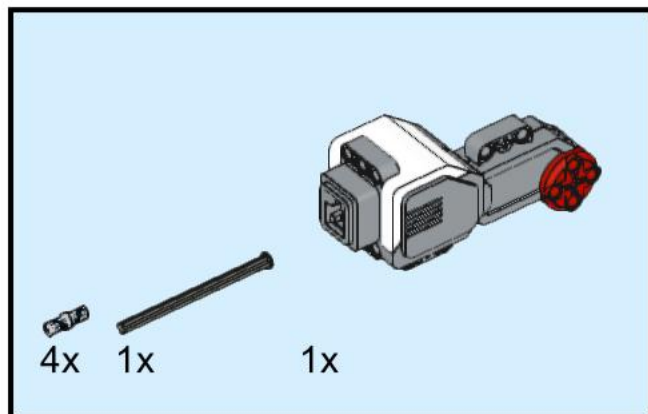

2

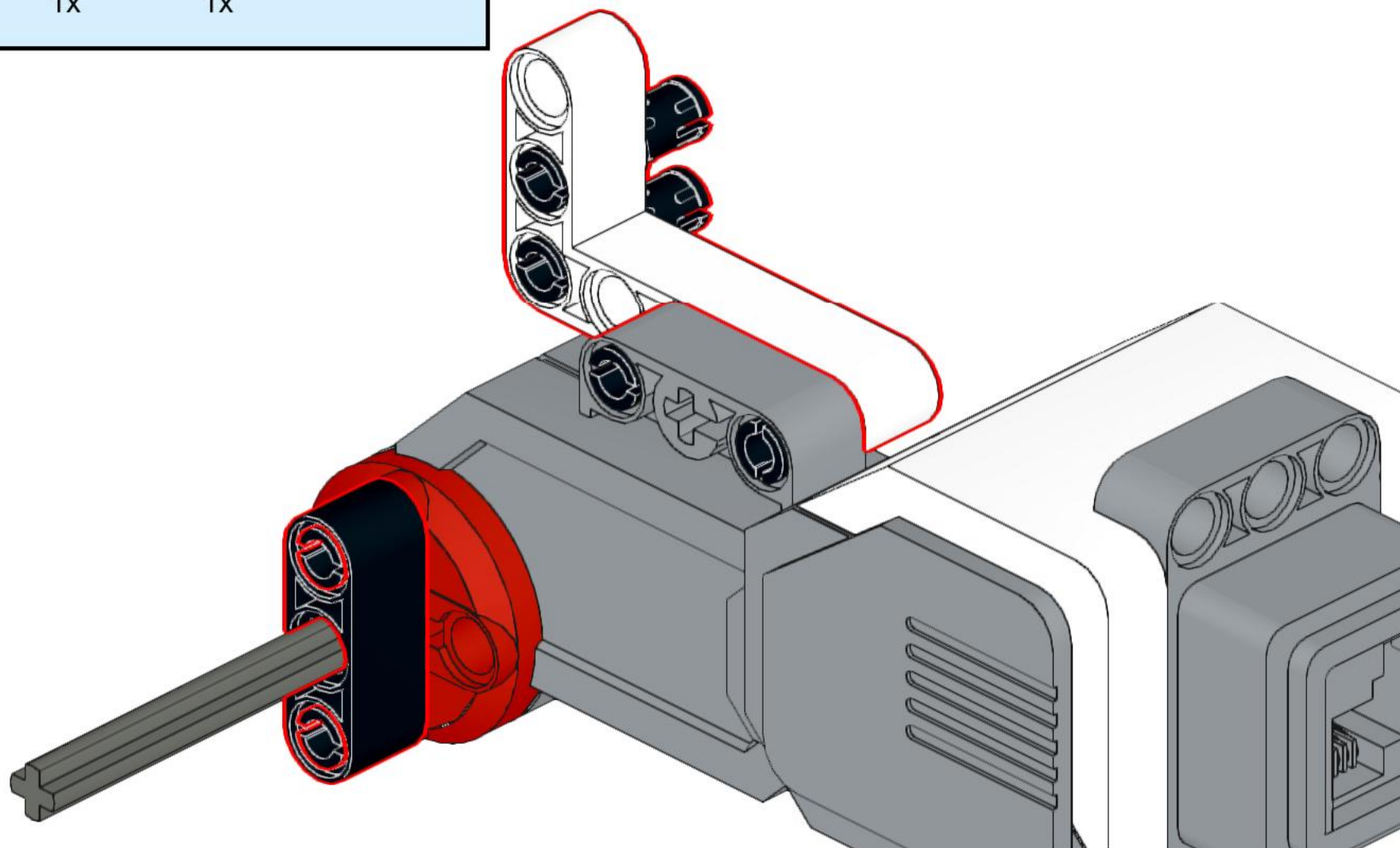
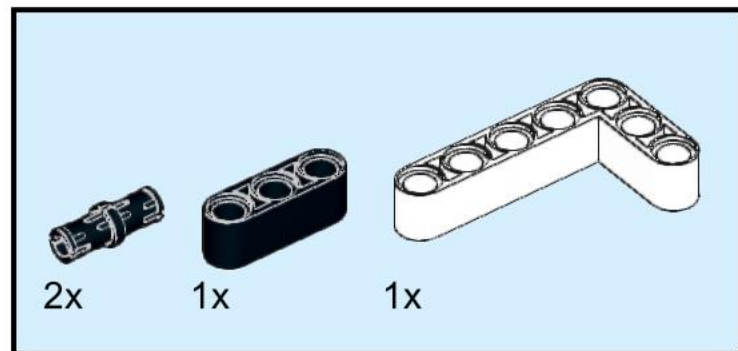

3

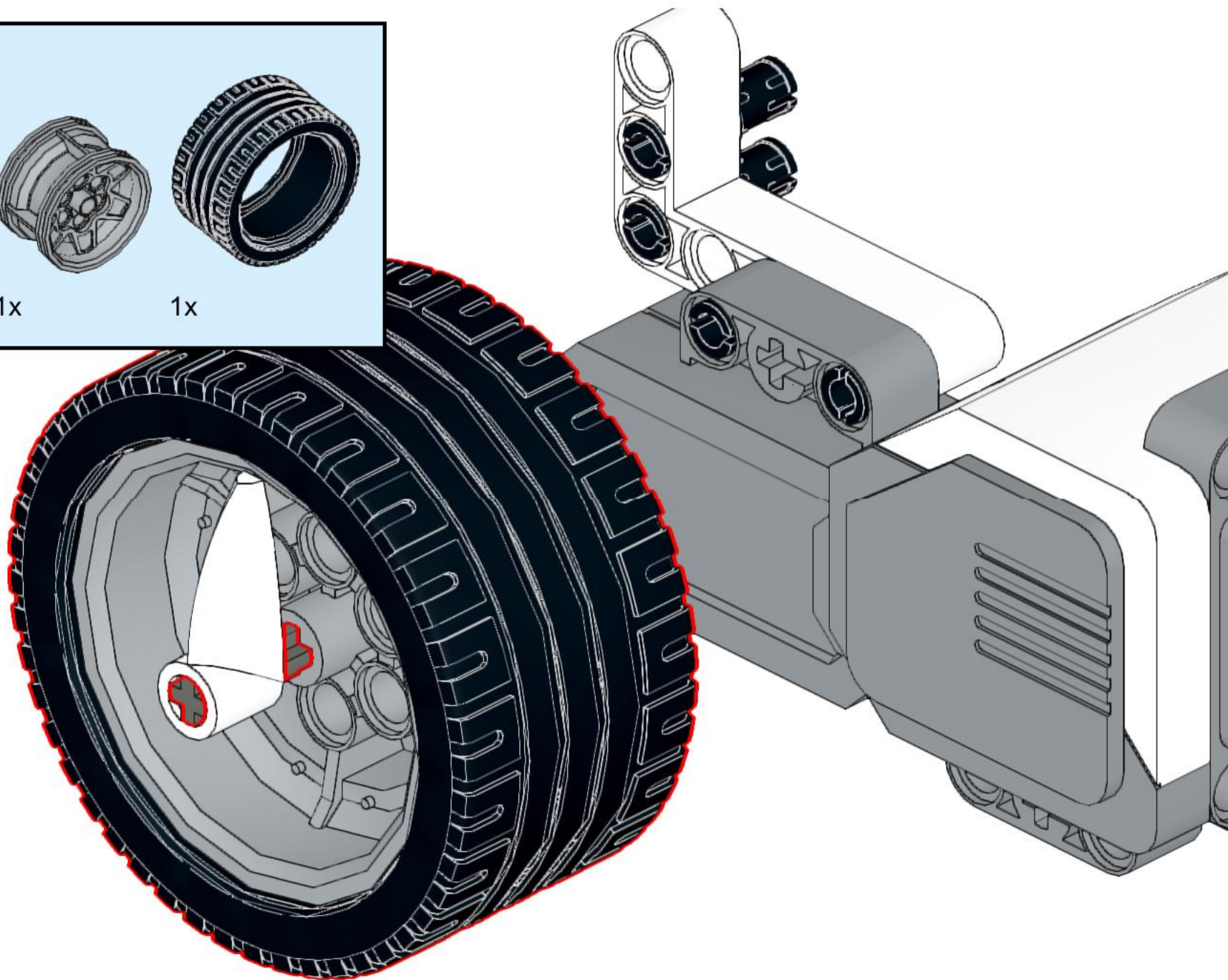
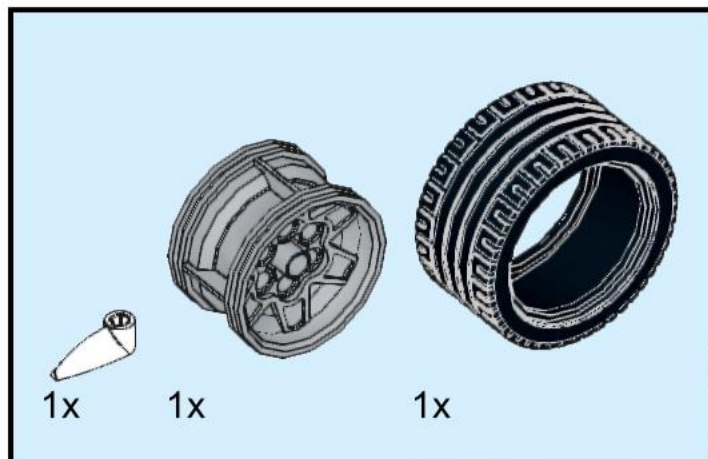

4

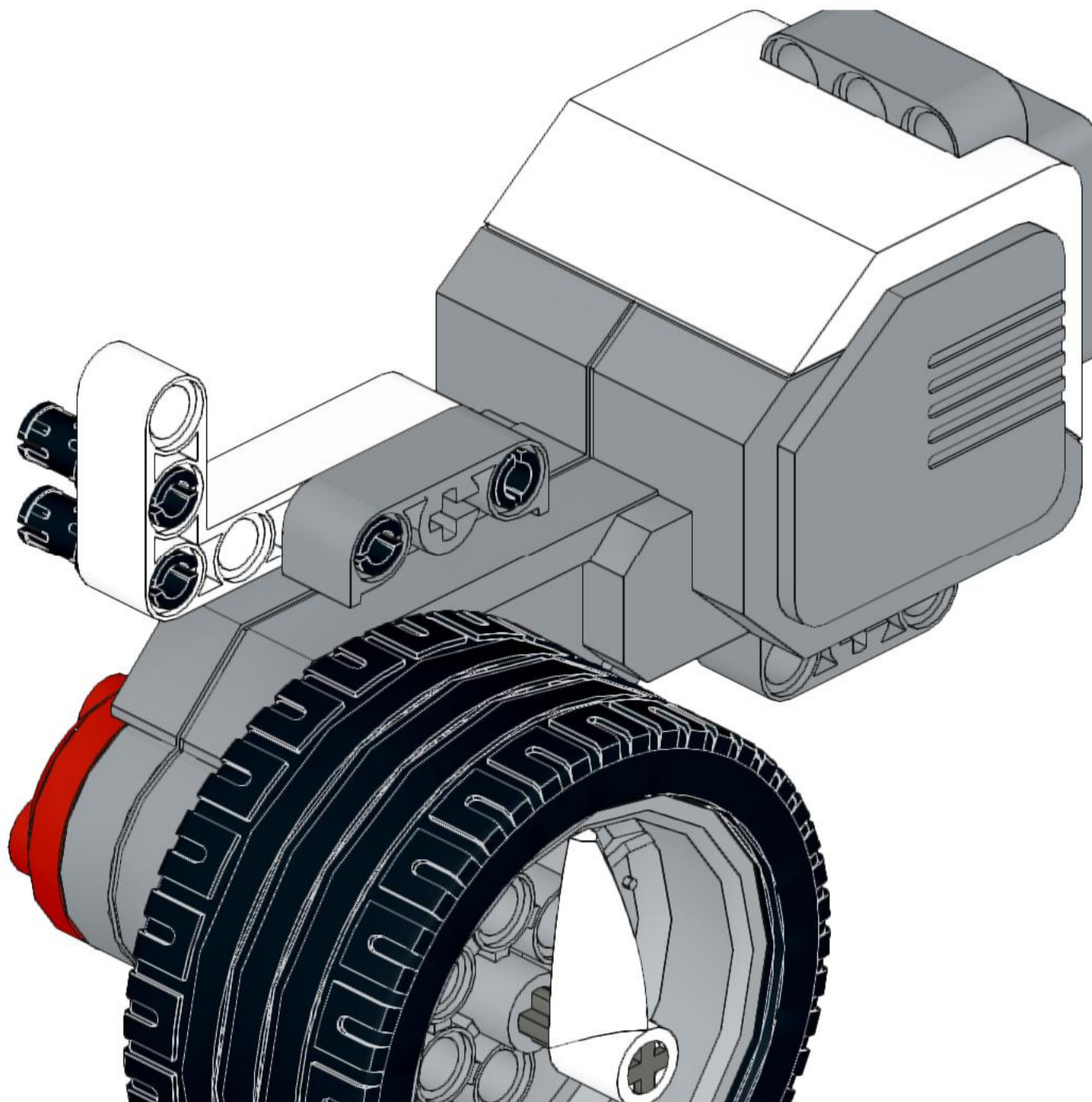

5

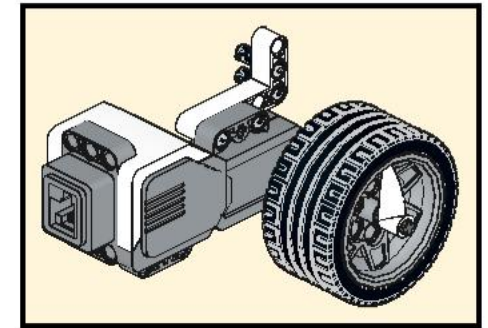
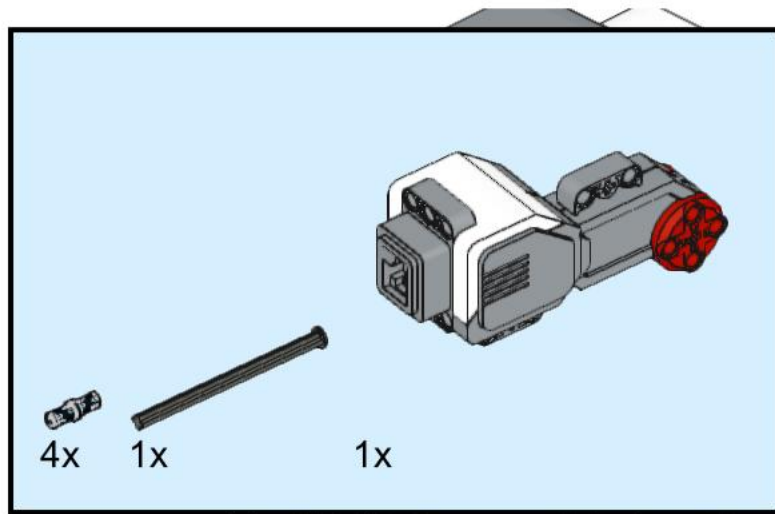

RIGHT MOTOR

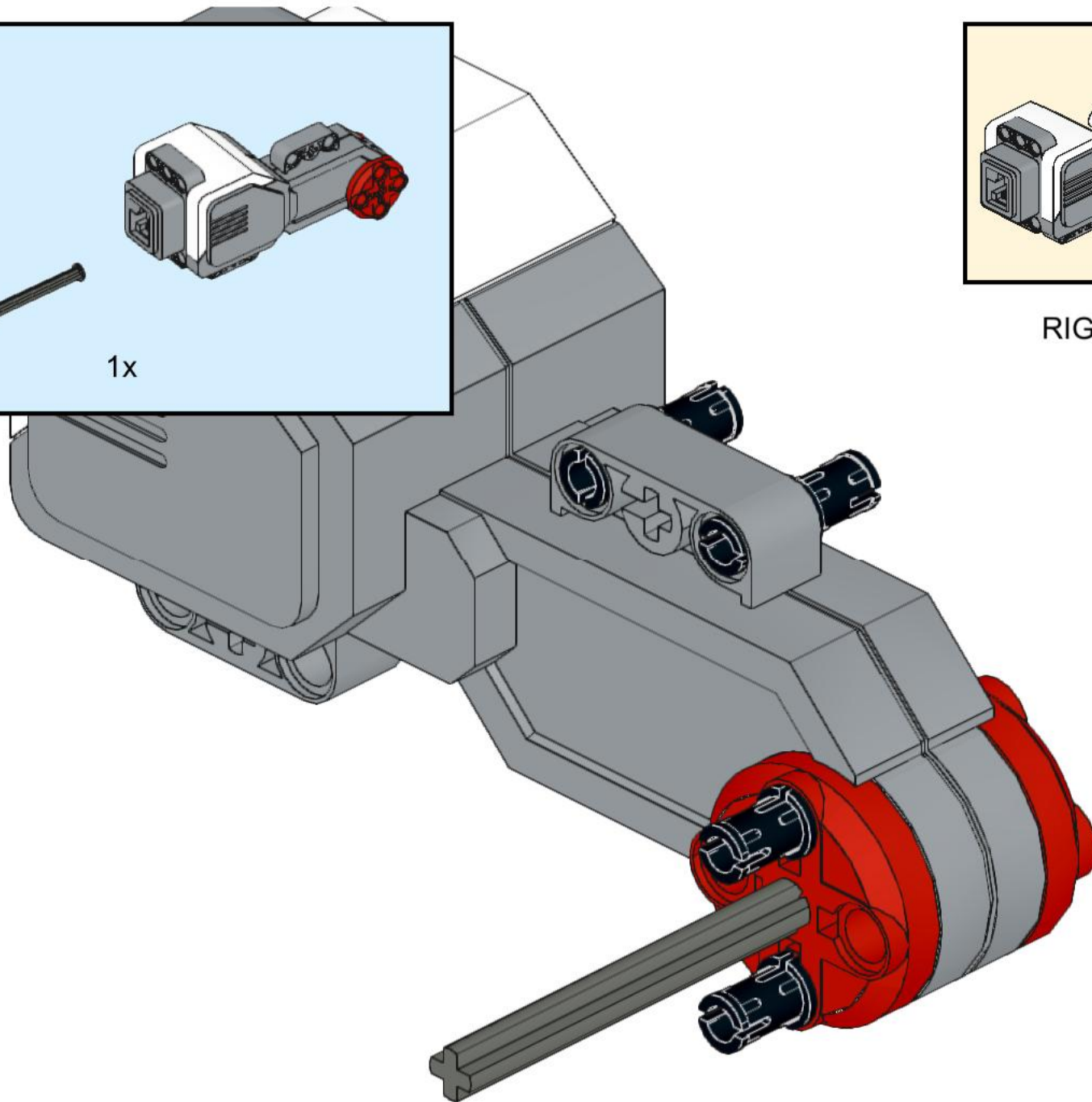

6

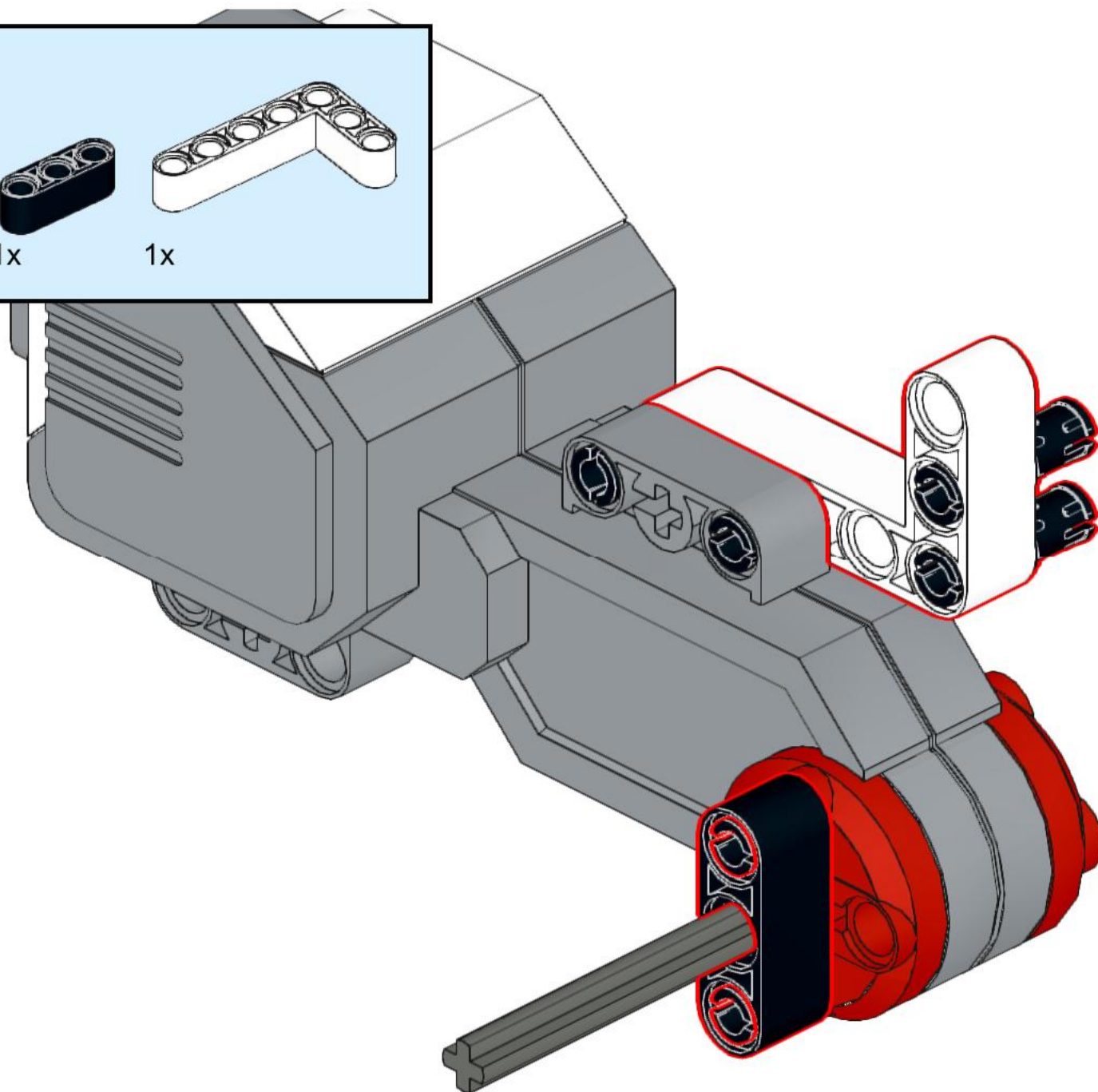
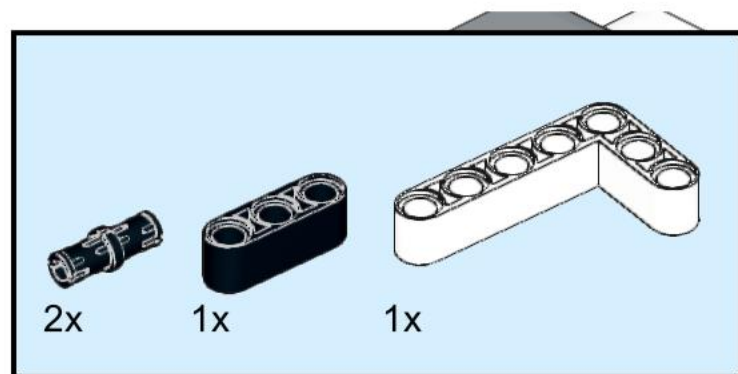

7

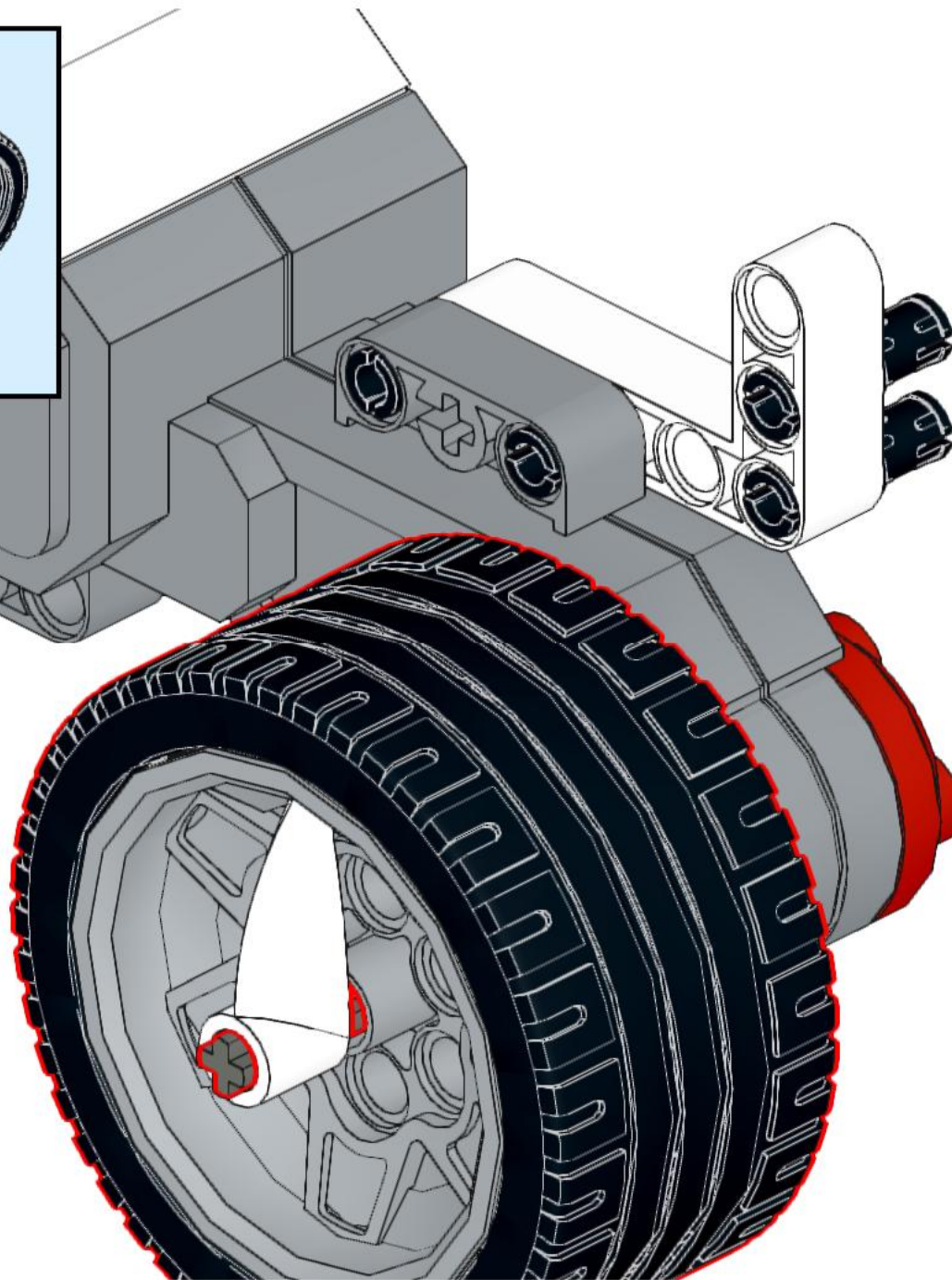

8

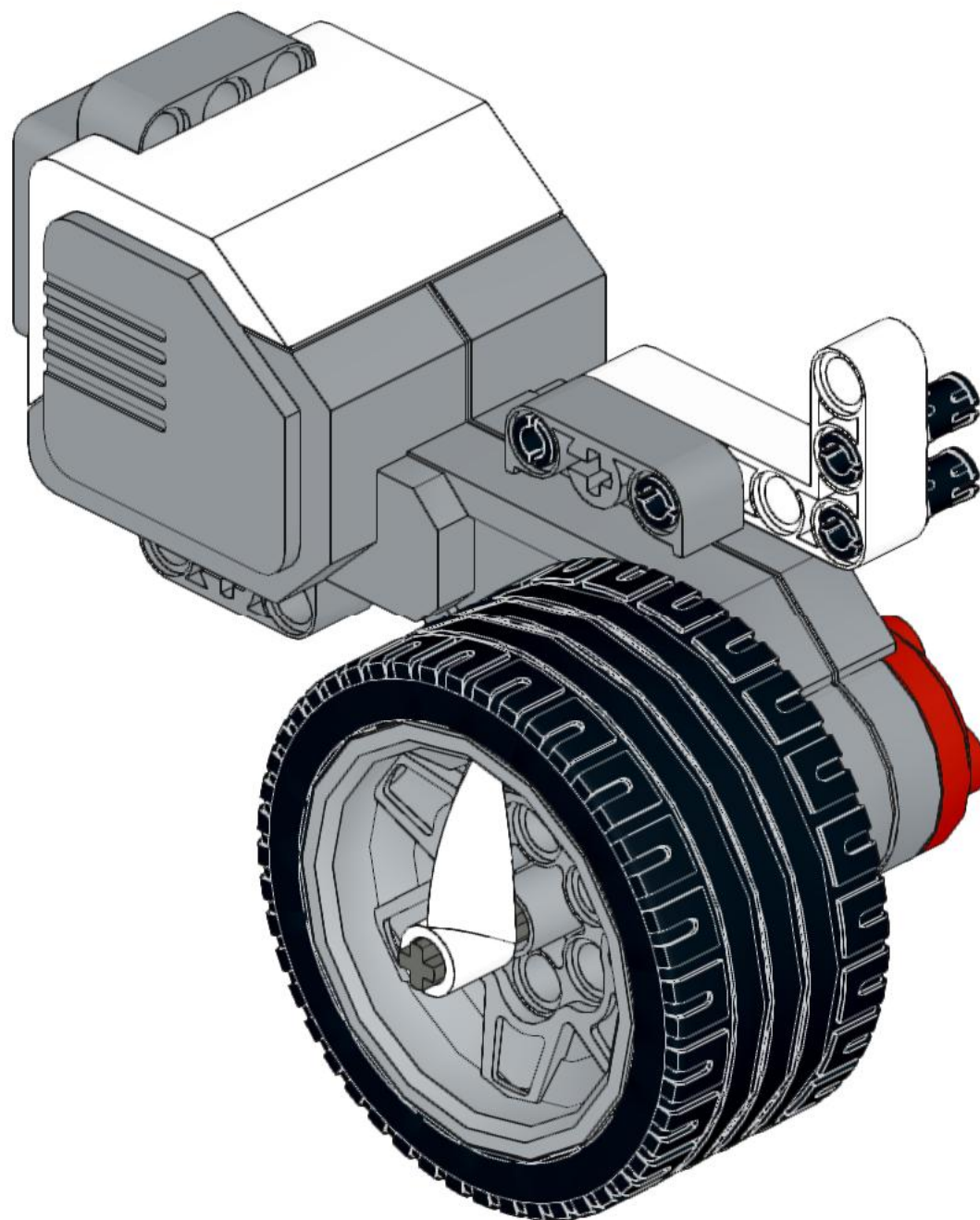

9

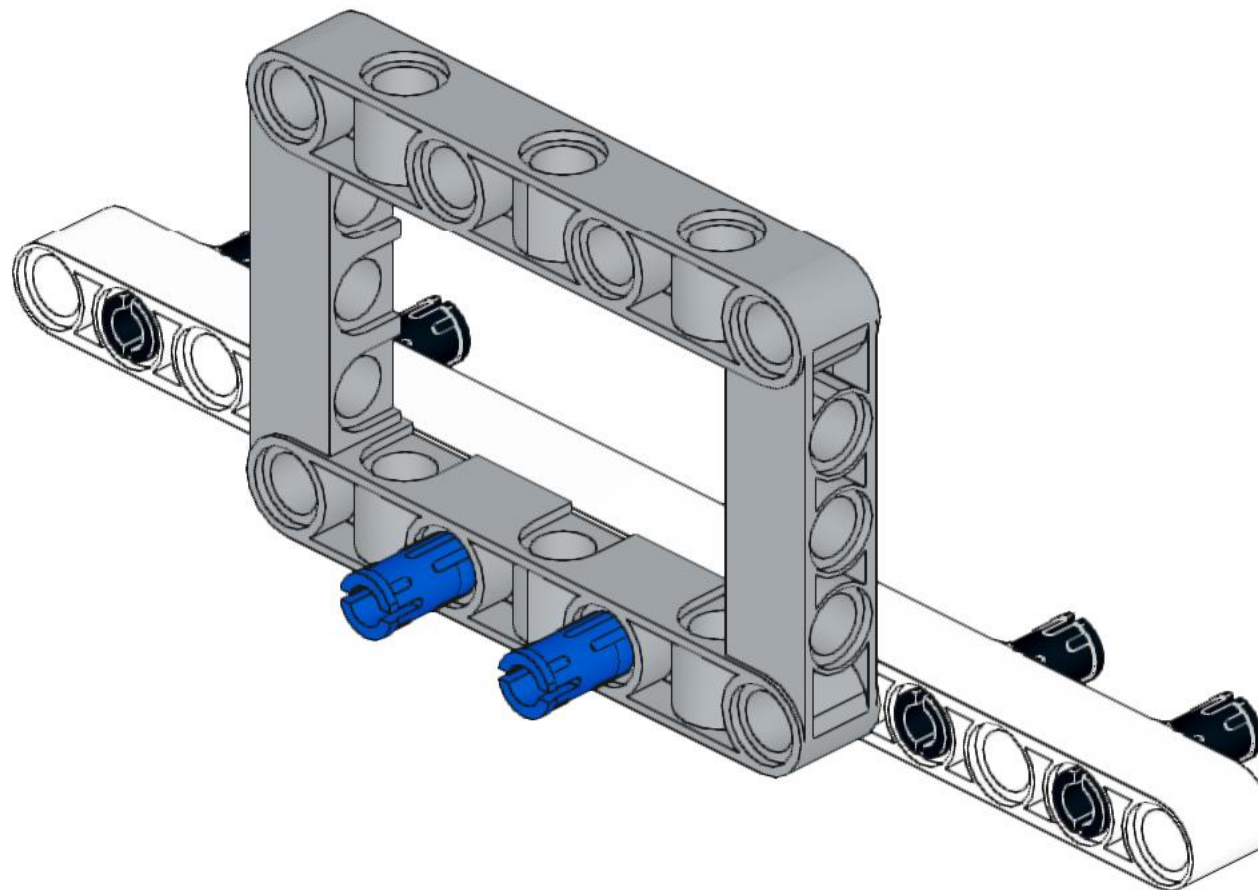
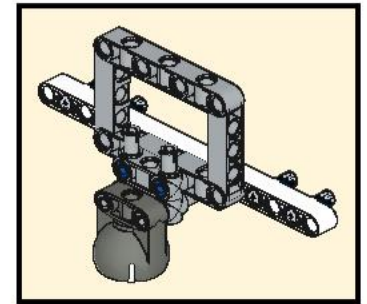
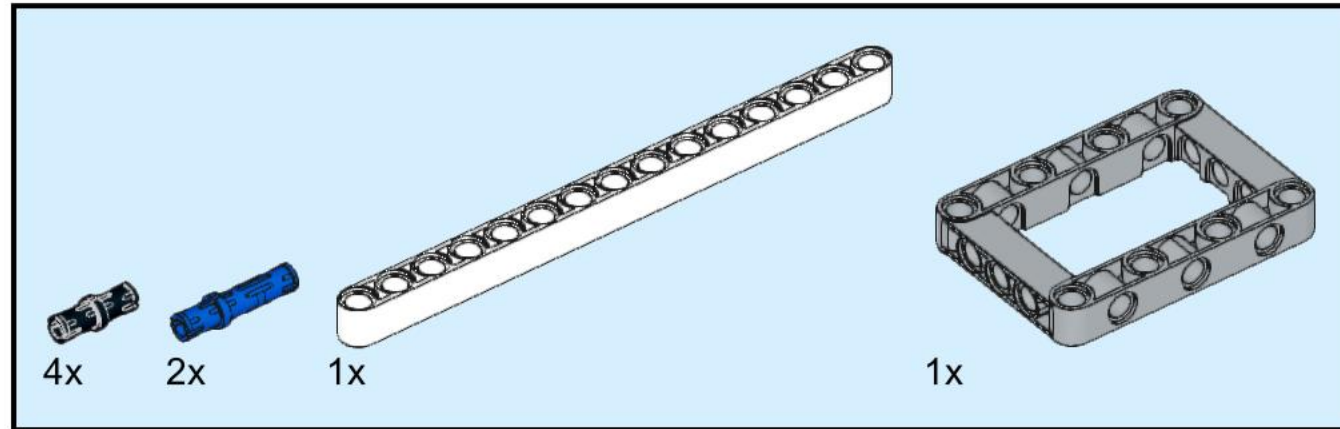

10

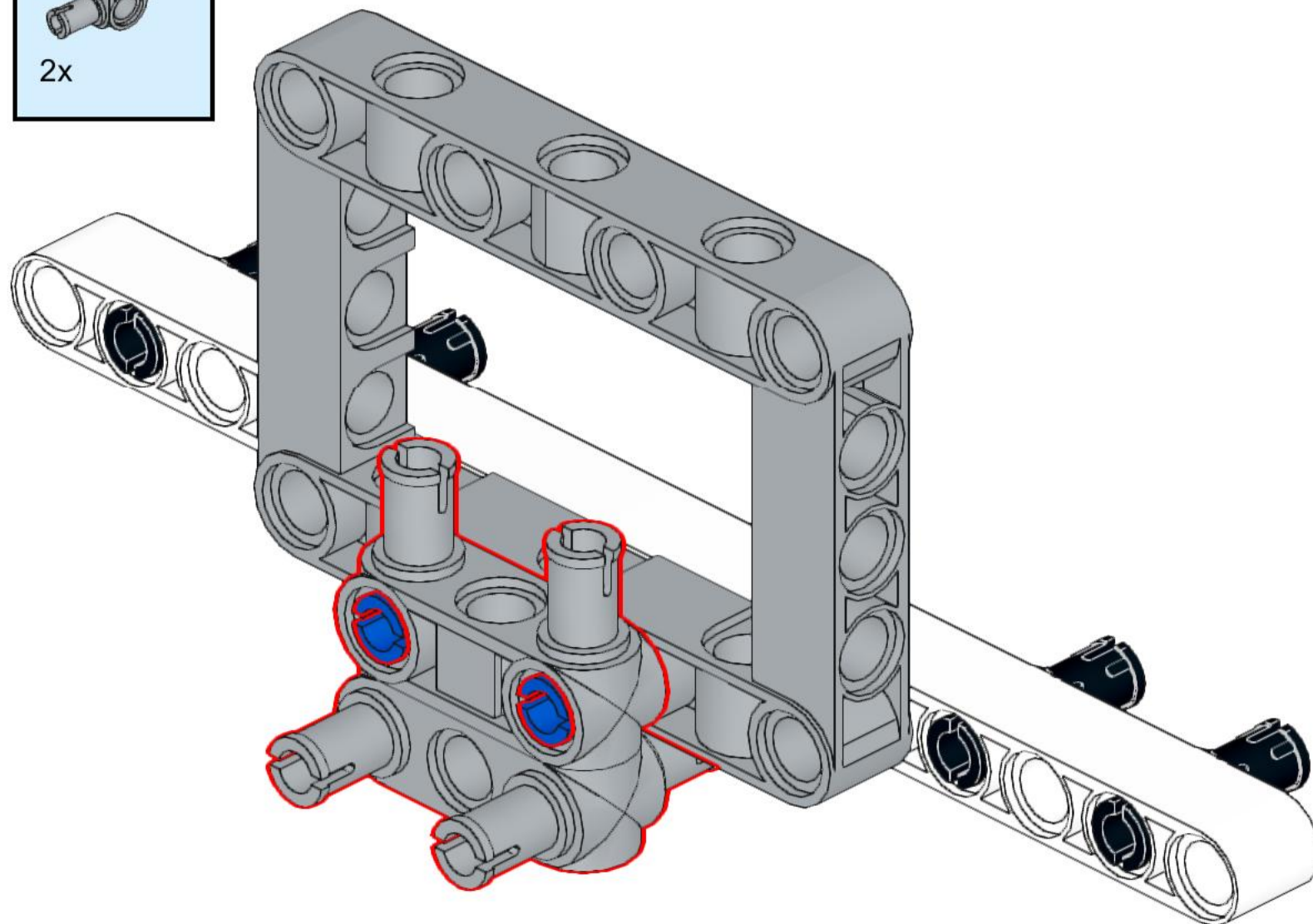
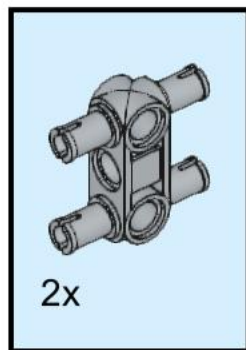

11

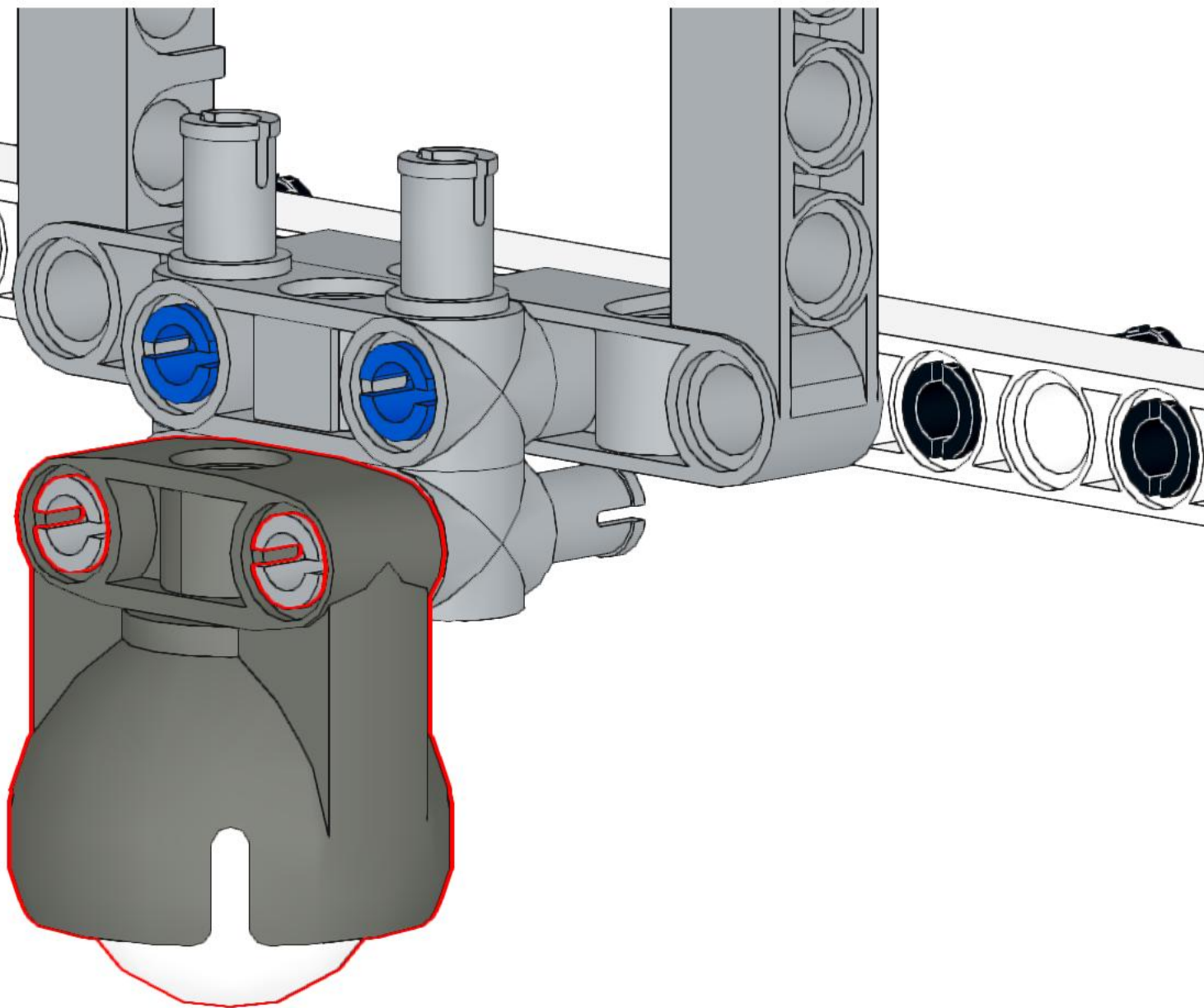
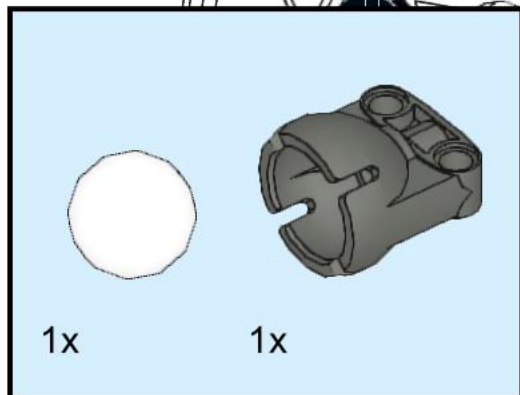

12

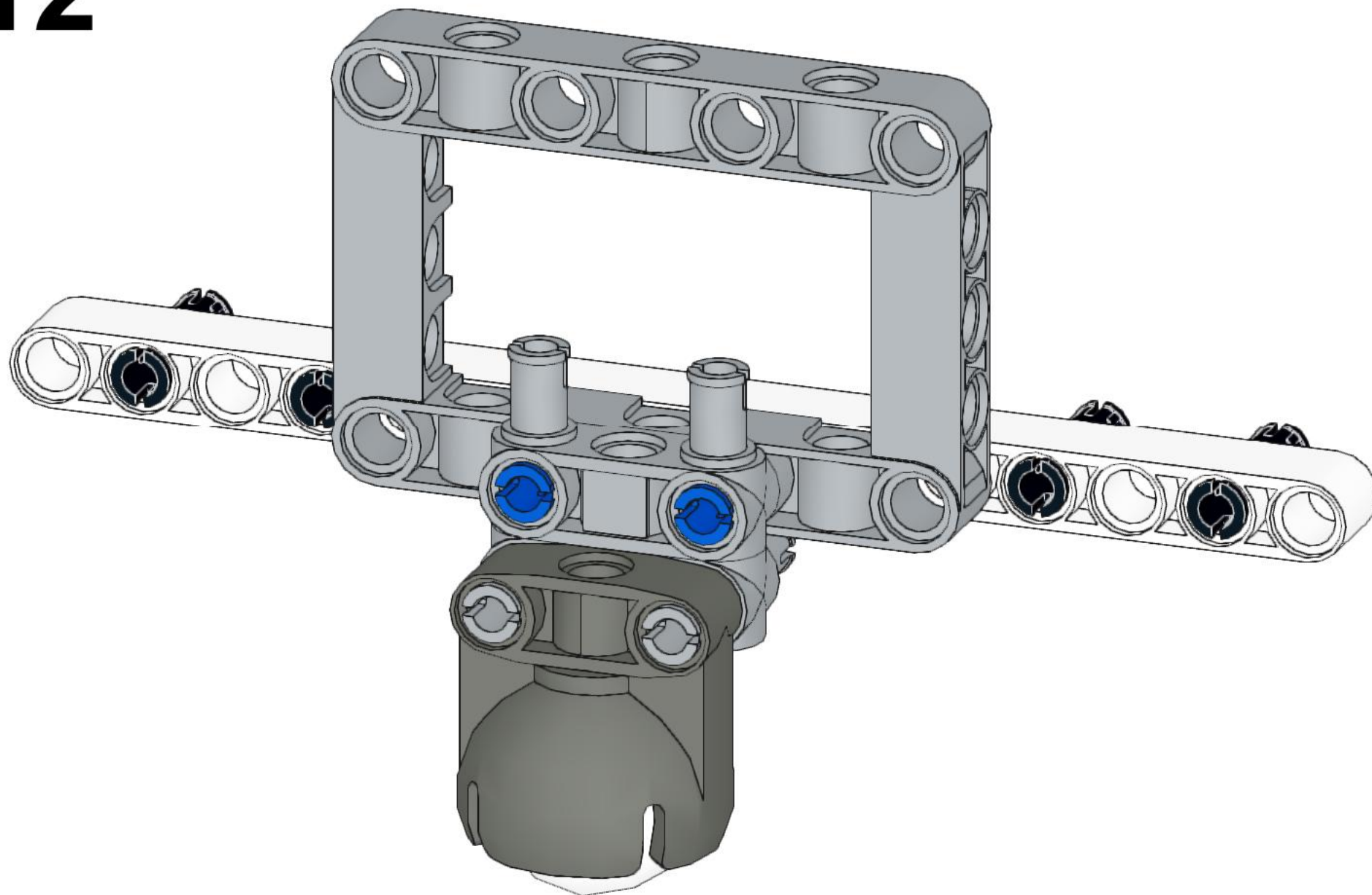

13

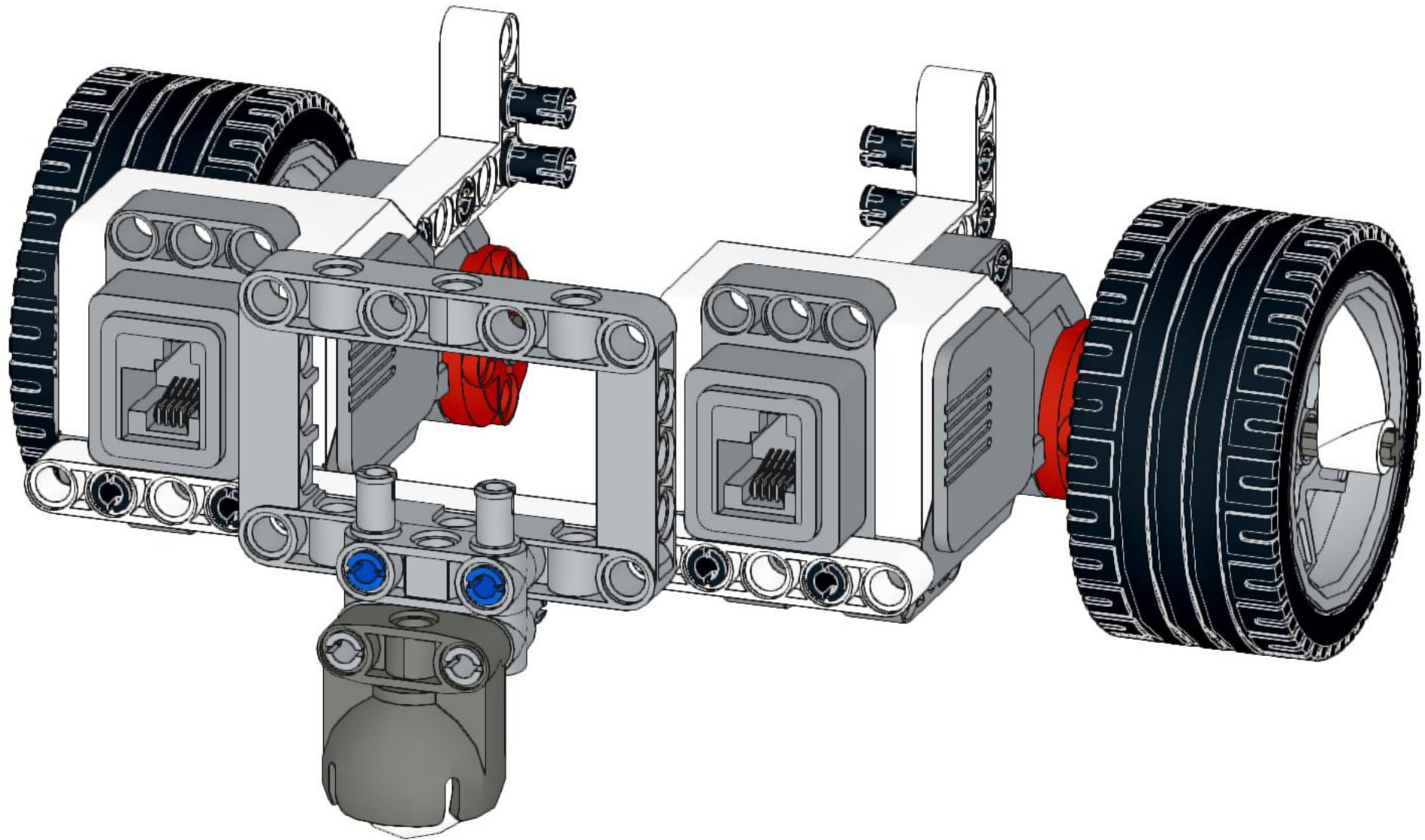

14

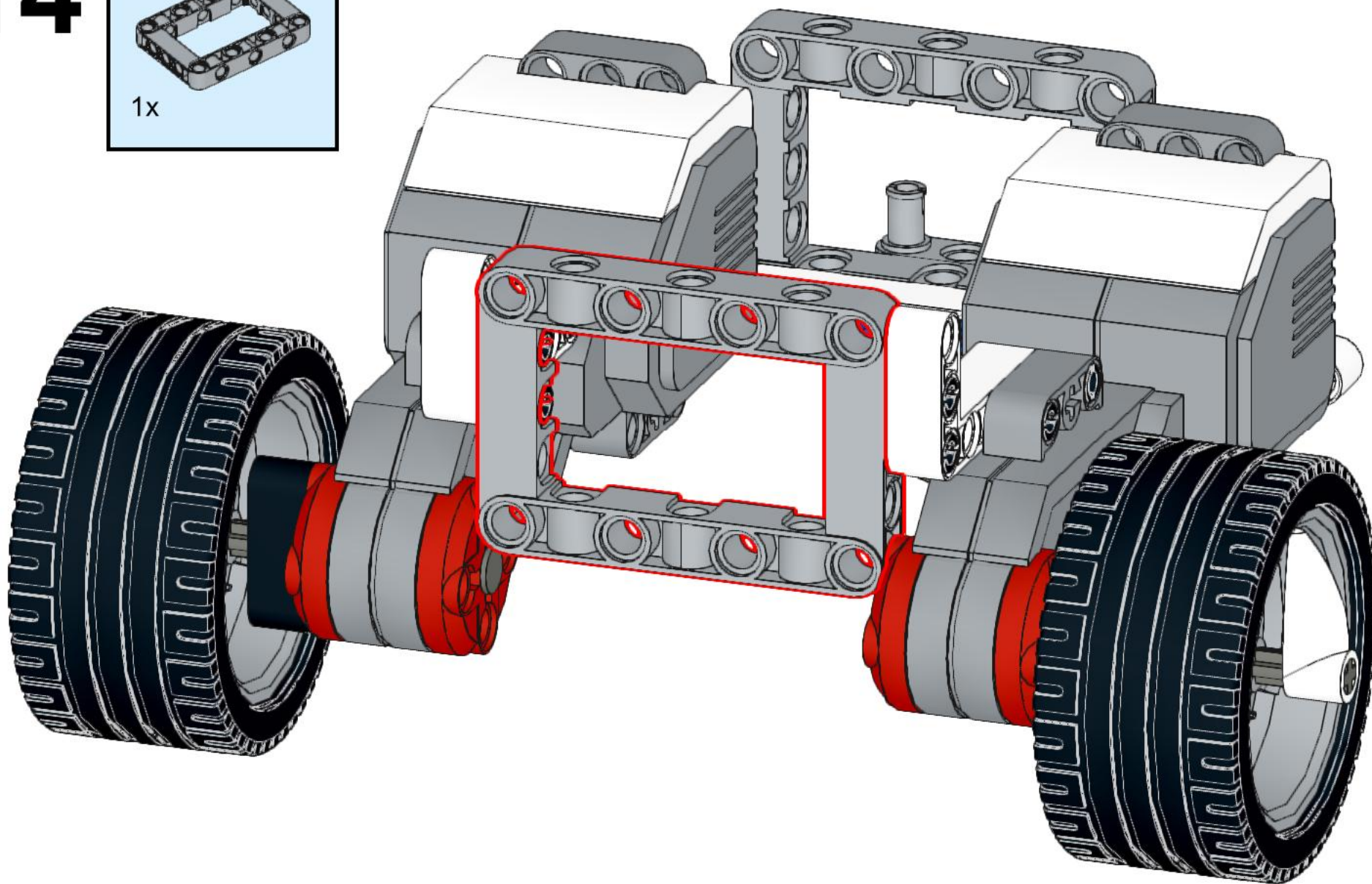
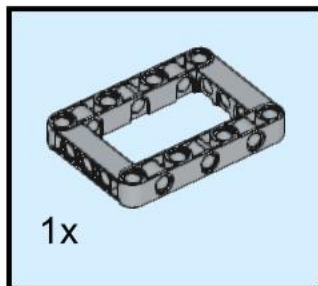

15

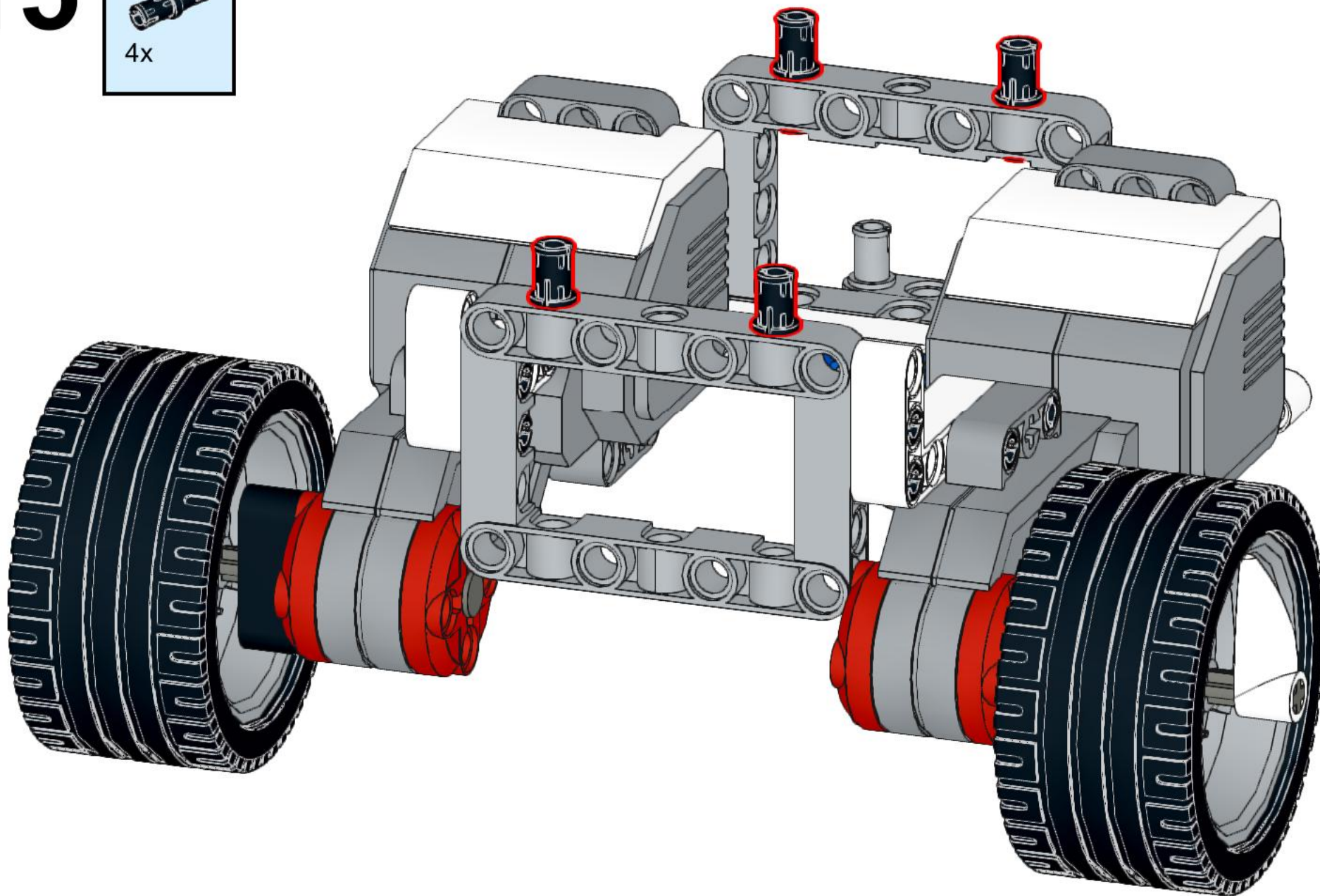

PARTE 2

(the gripper)

16

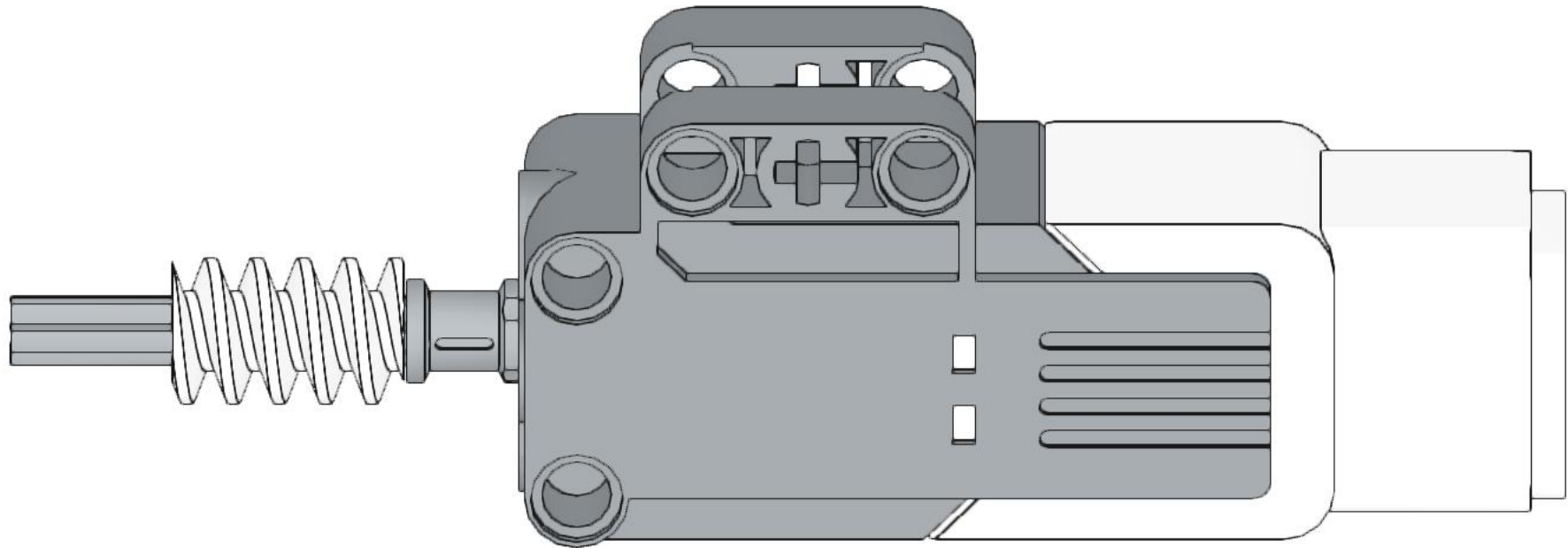
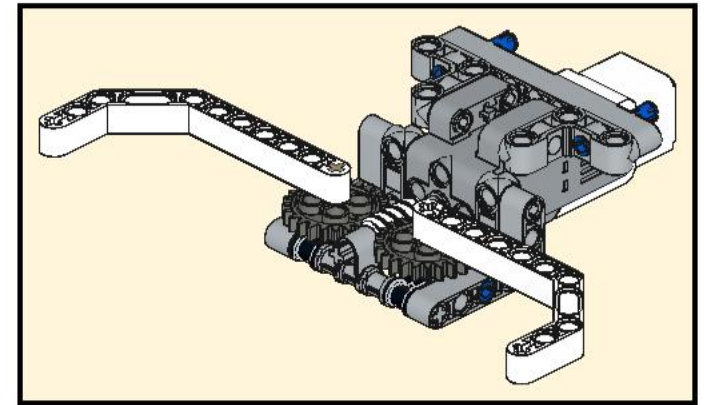
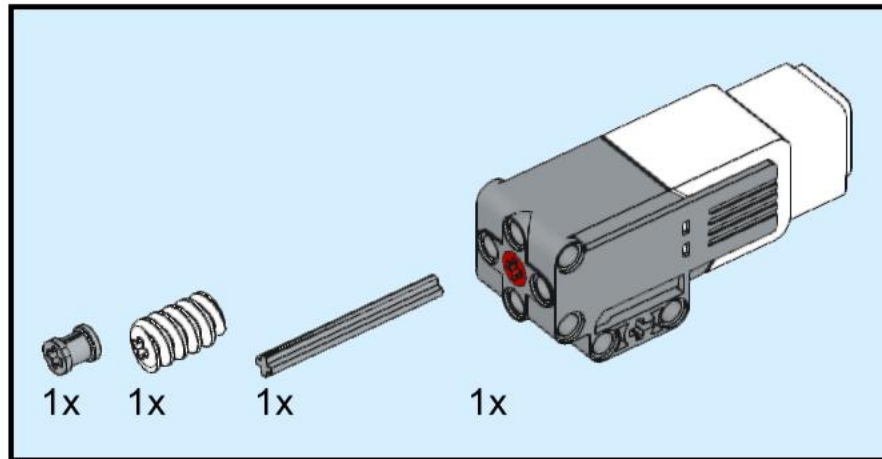

17

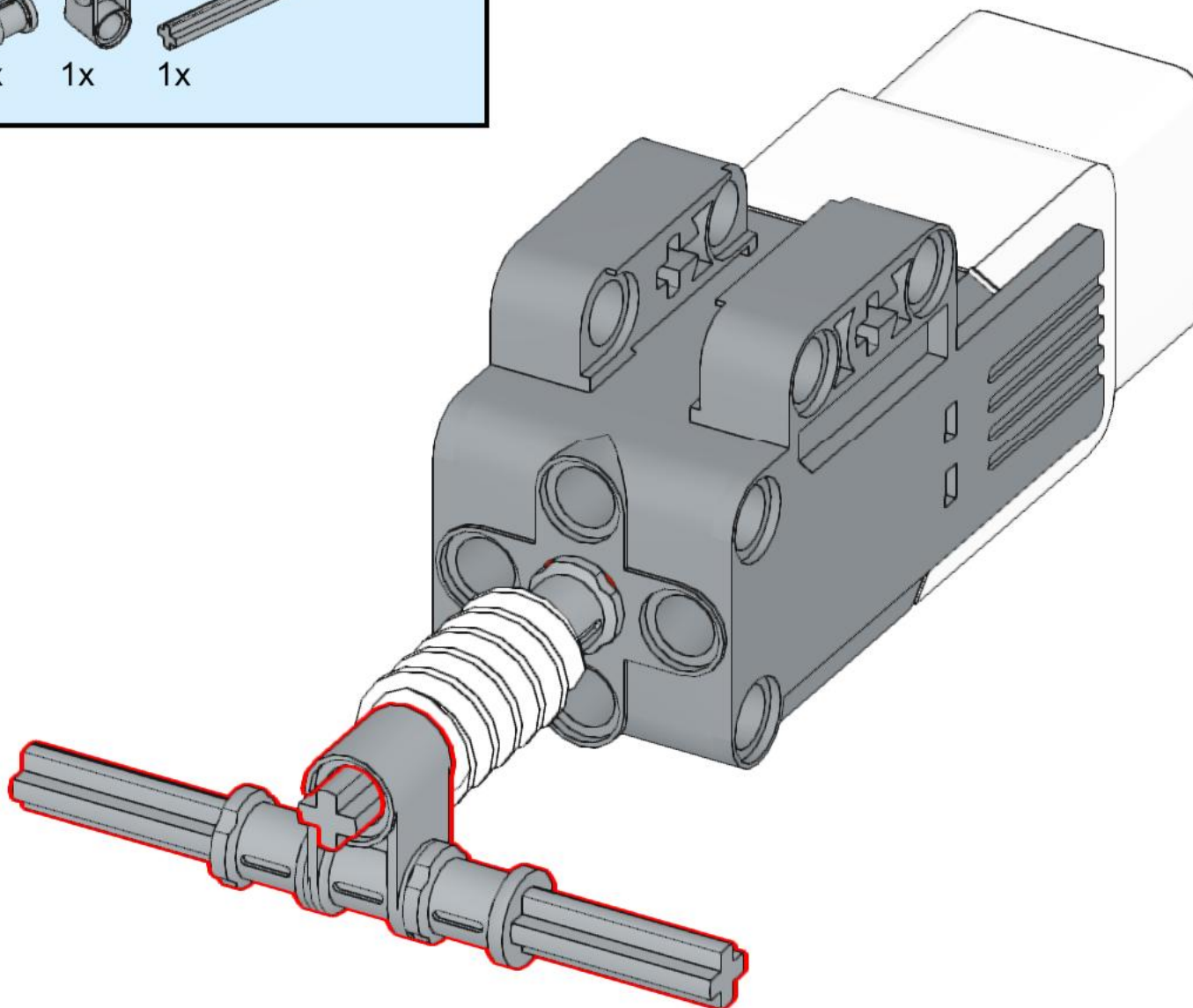
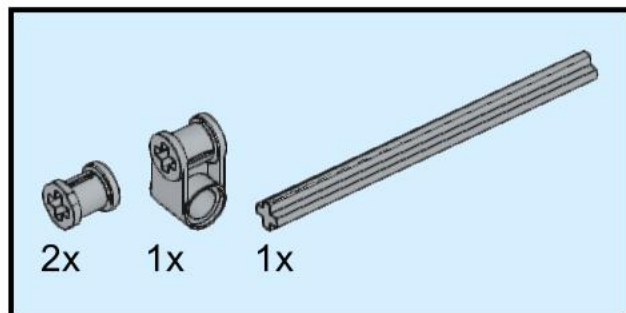

18

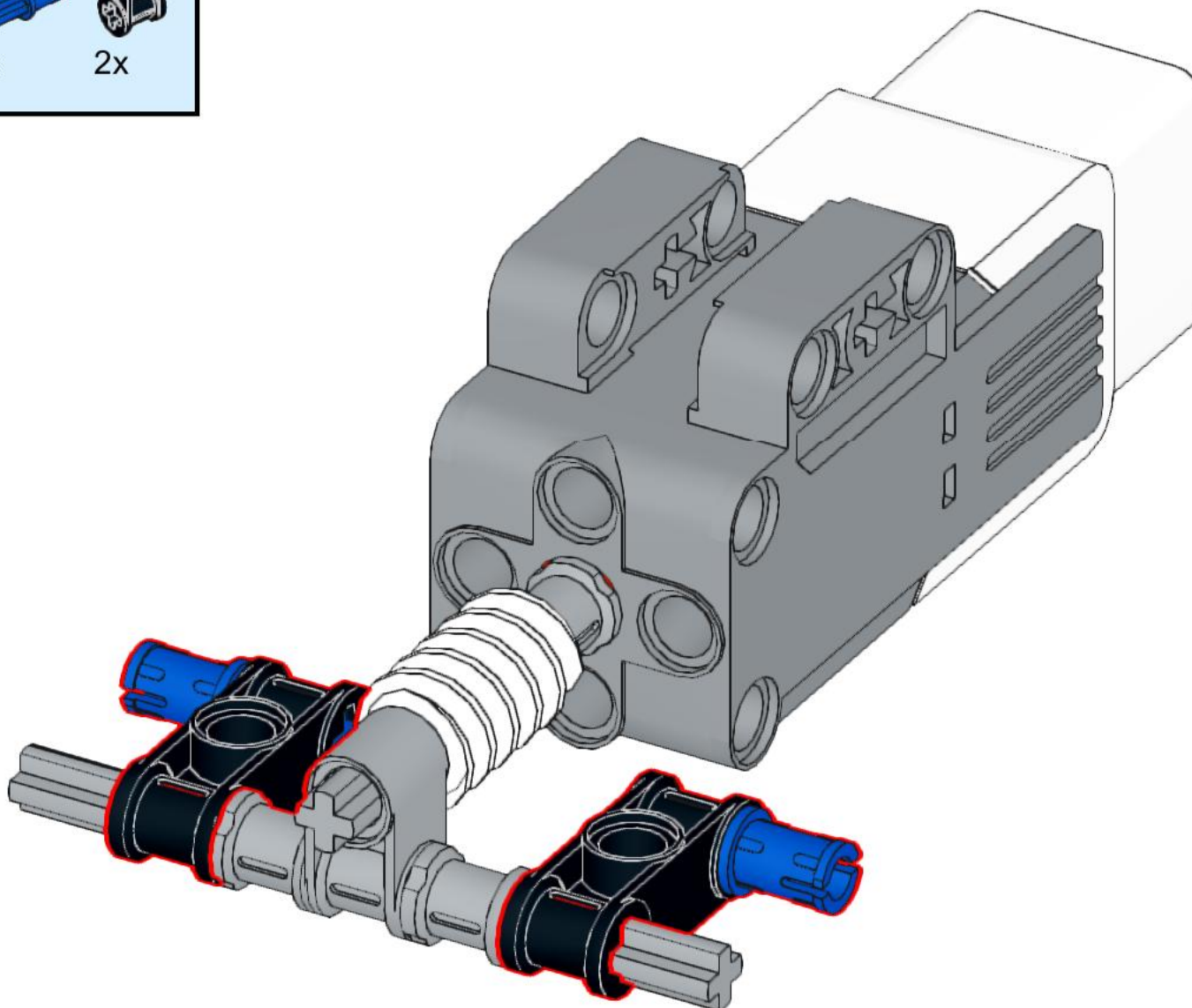
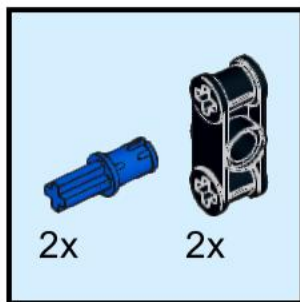

19

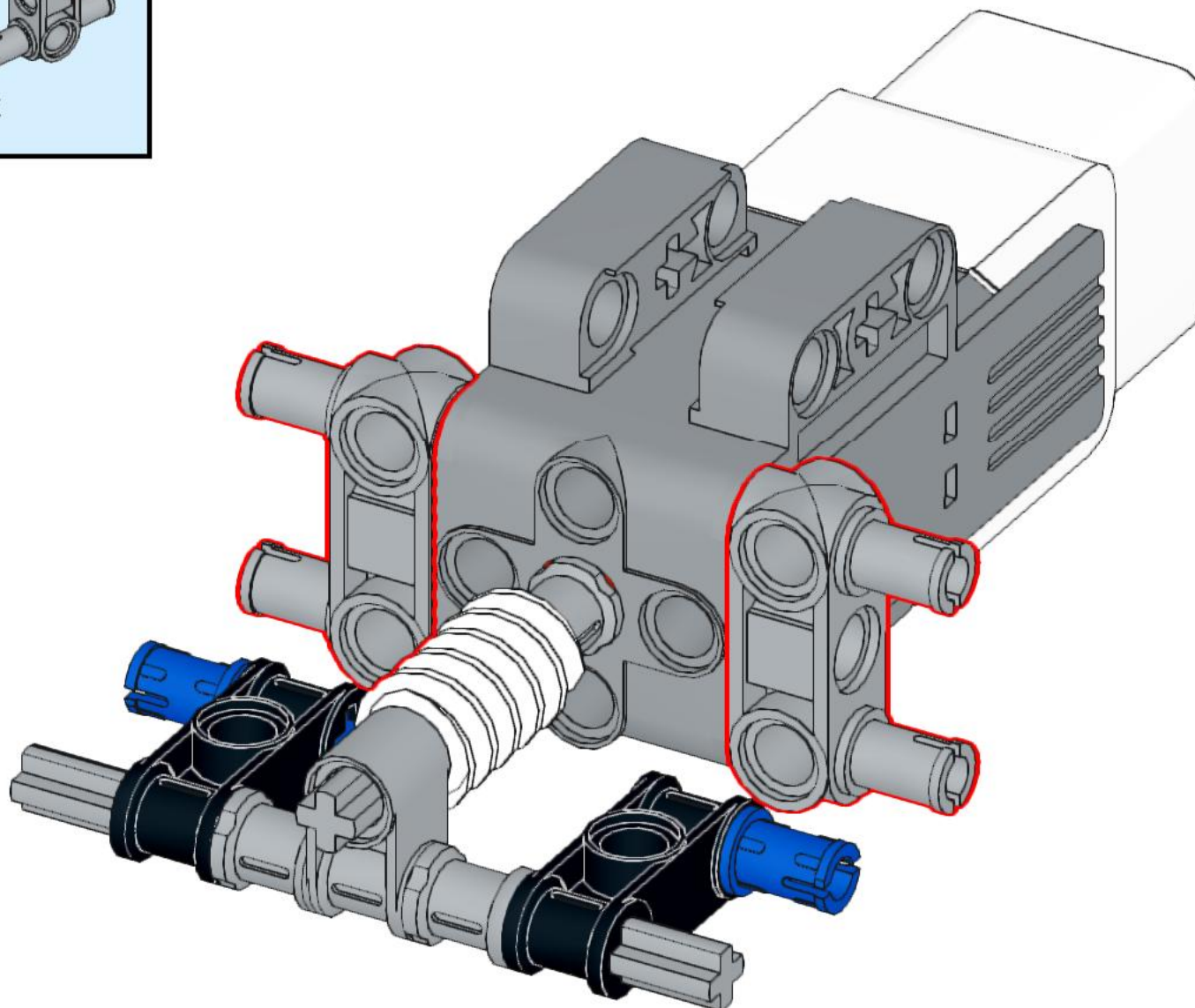
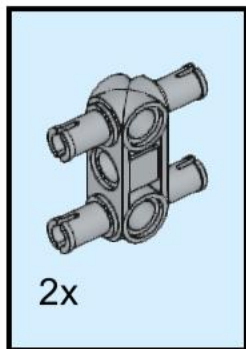

20

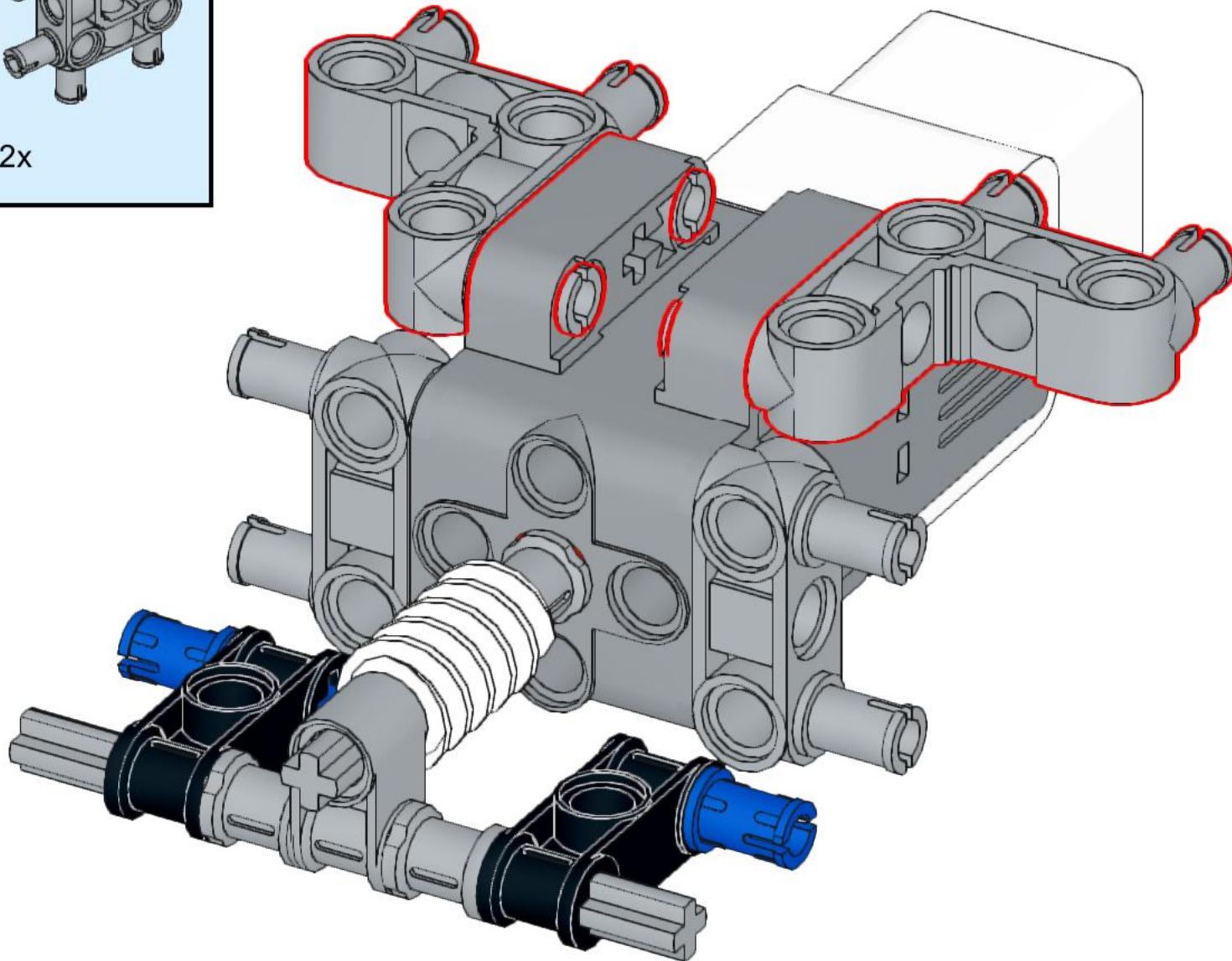
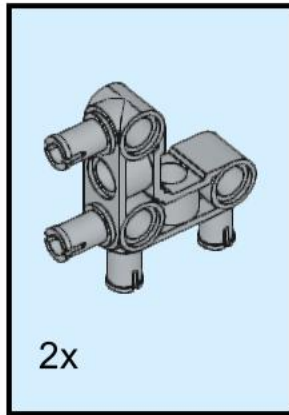

21

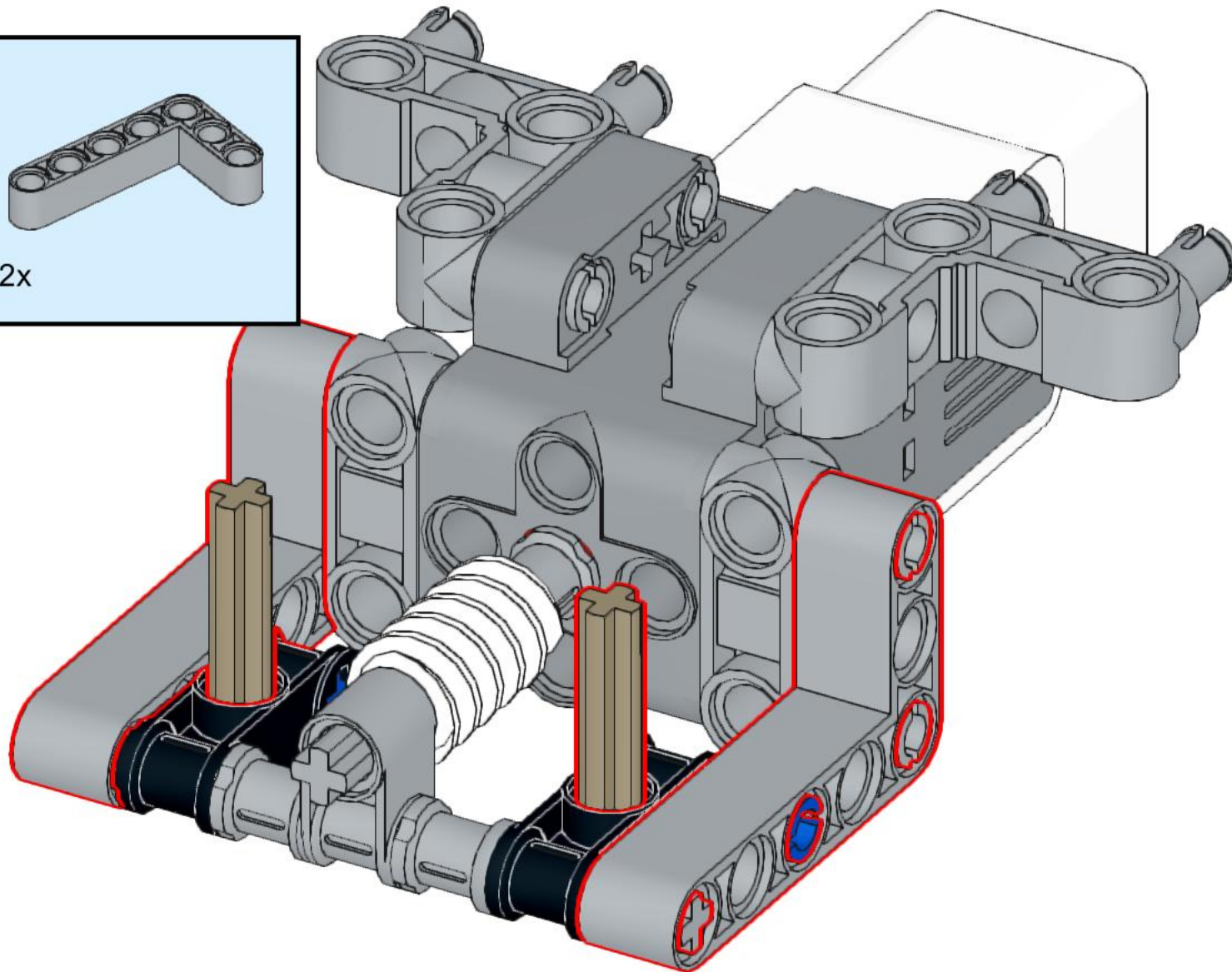
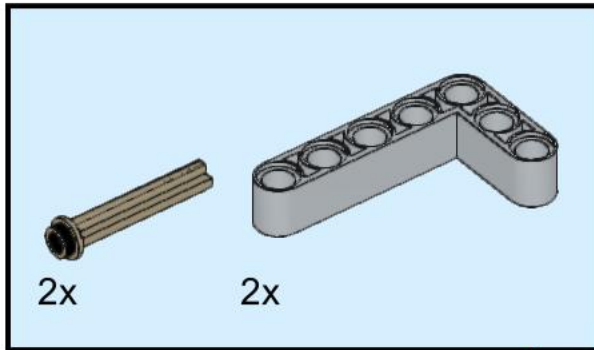

22

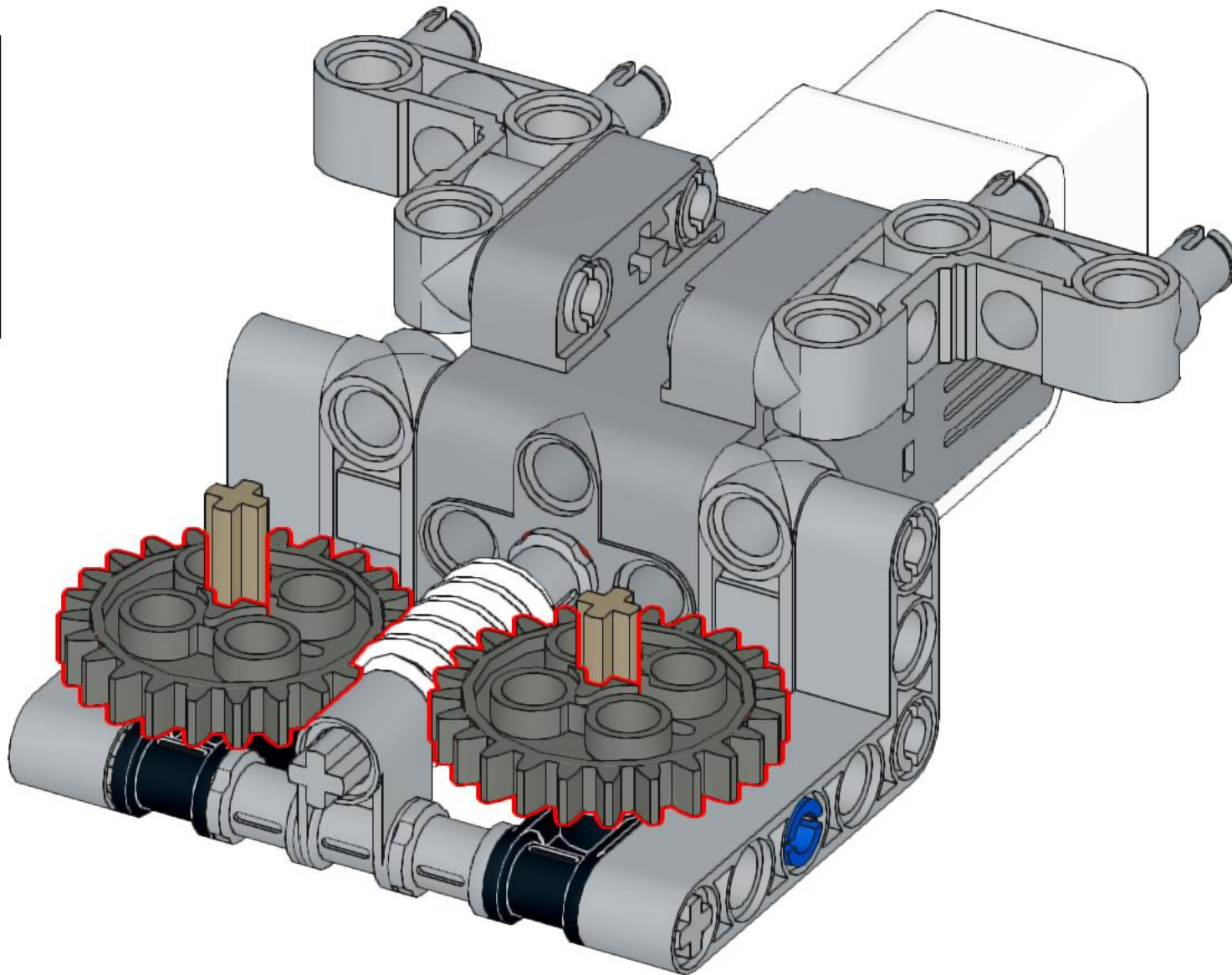
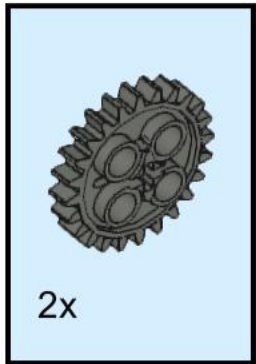

23

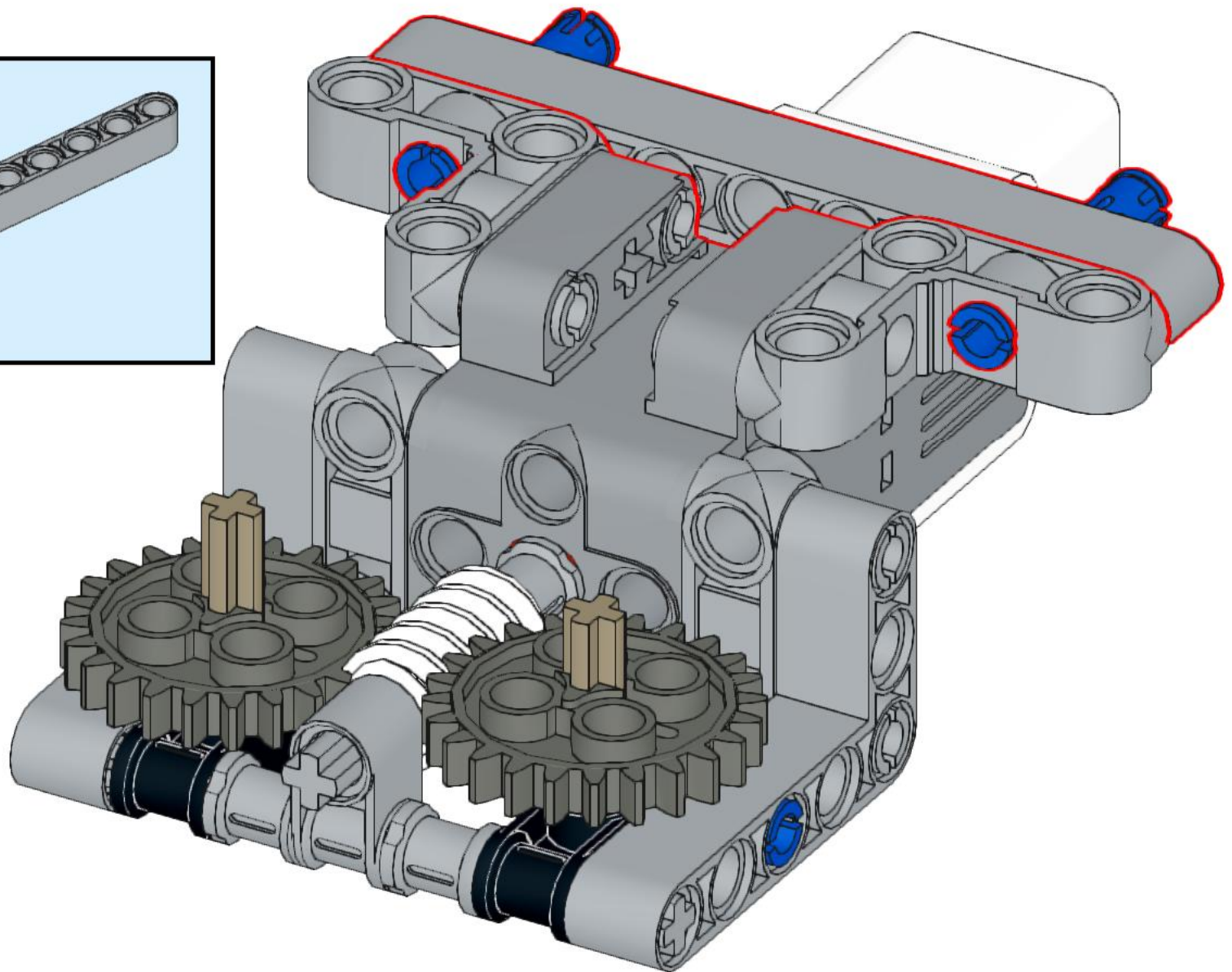
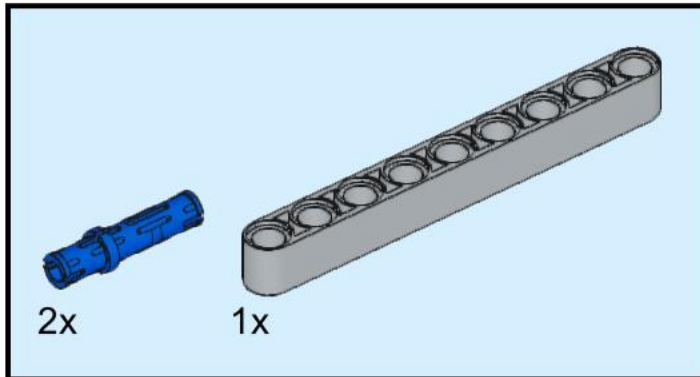

24

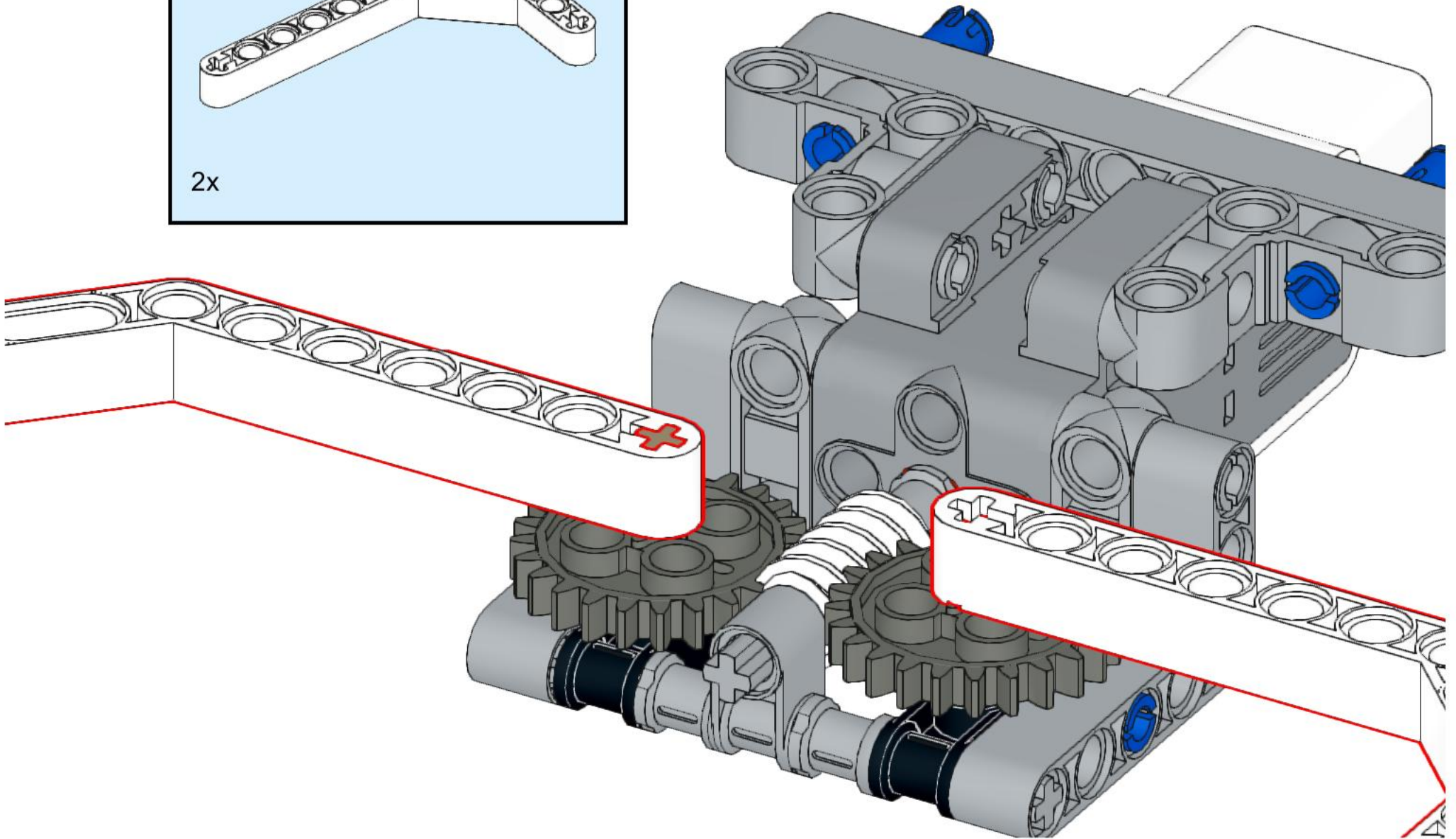
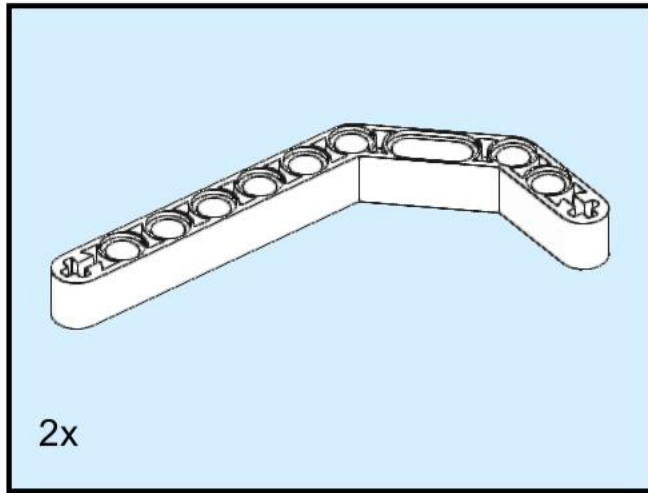

25

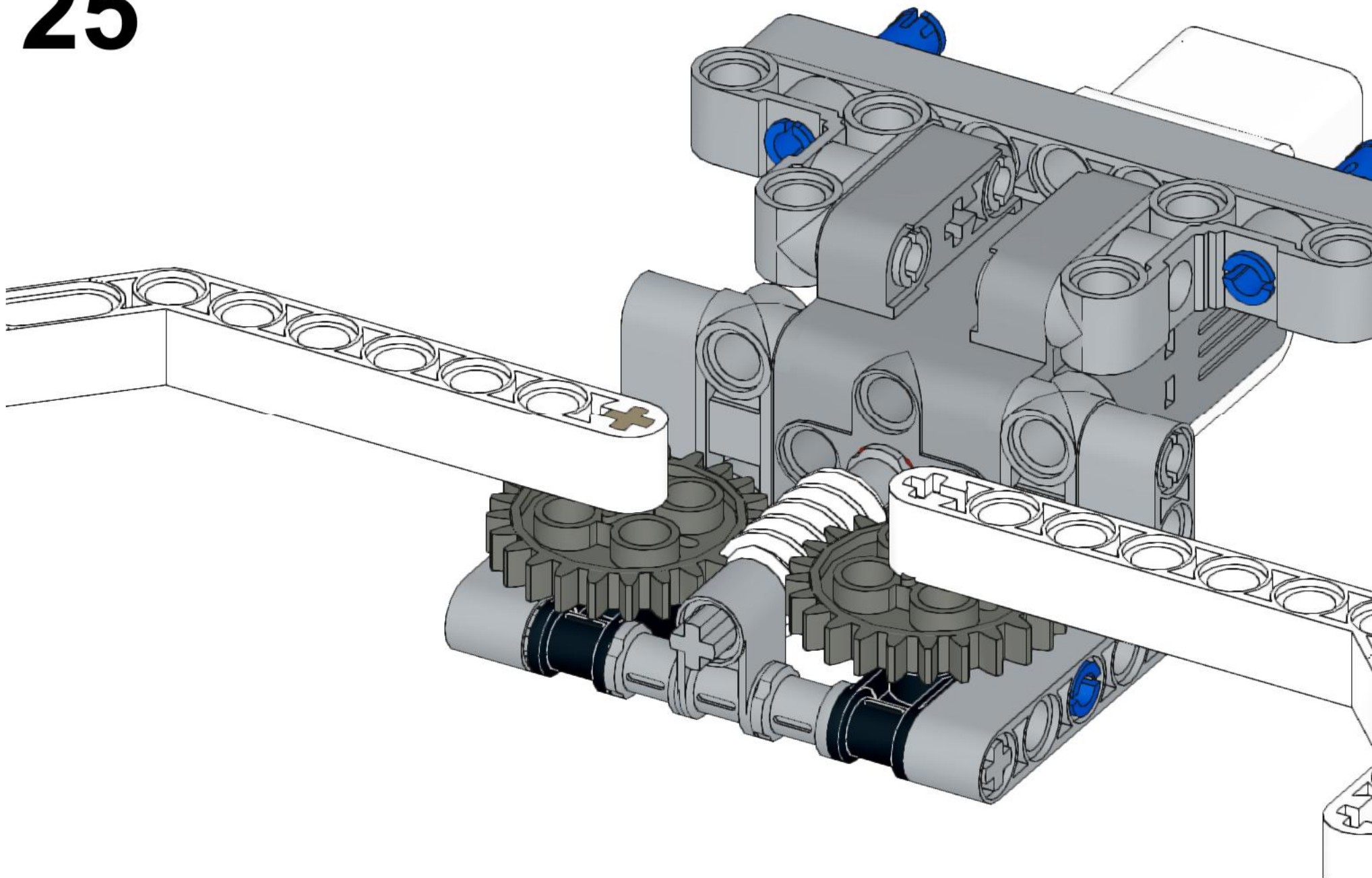

26

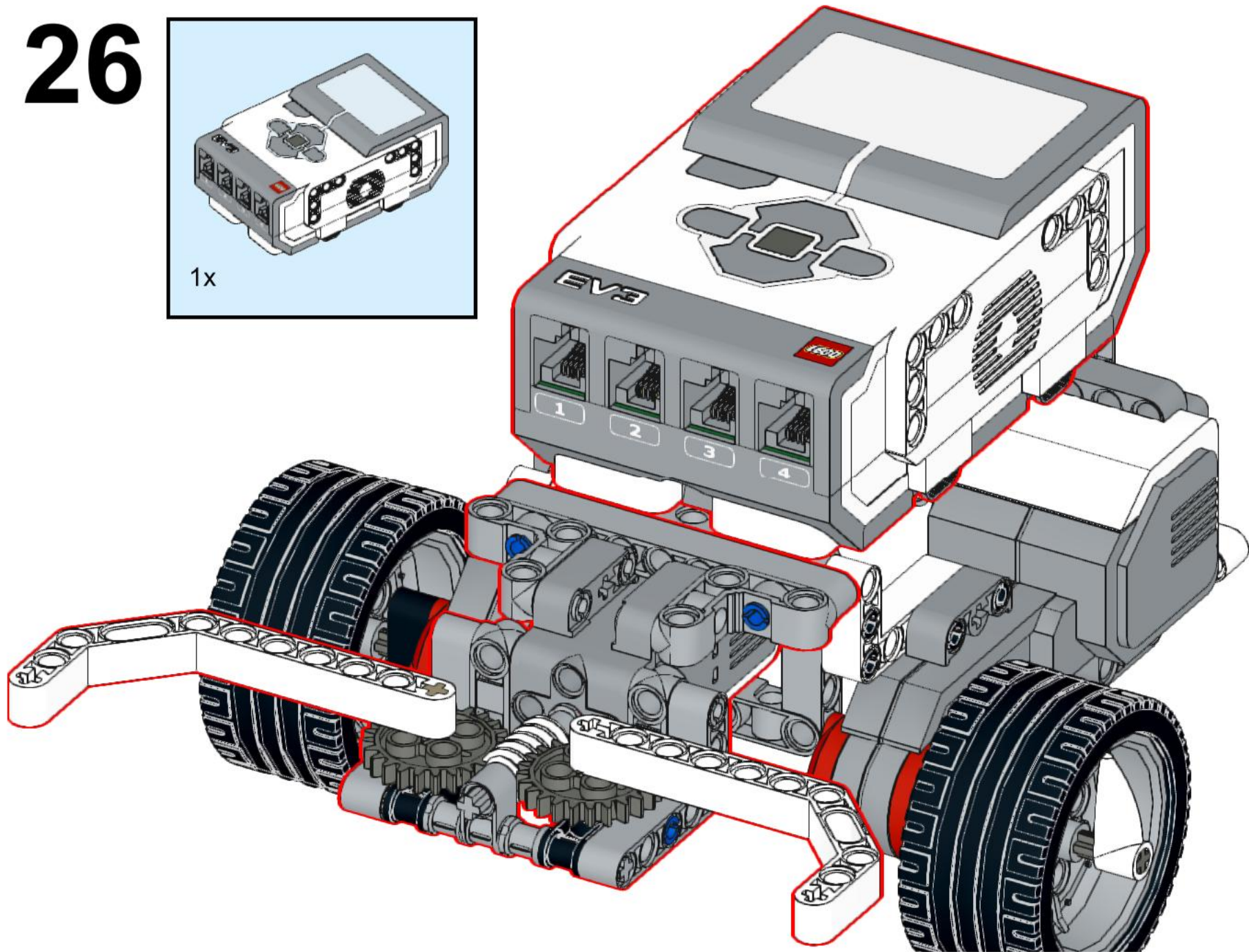
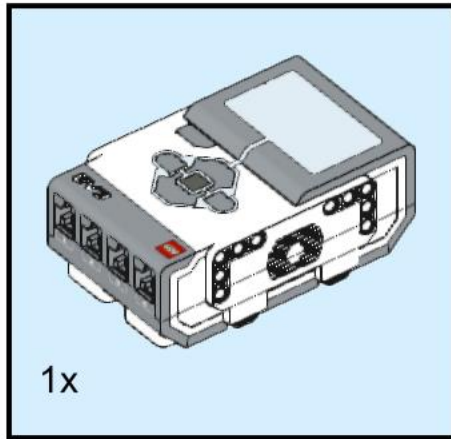

PARTE 3

(the software)



1) Connections:

PORT A to right motor;
PORT D to left motor;
PORT B to gripper motor.

2) Install the App to control the robot using bluetooth

3) Change settings on the App



**Download the App
RemotEV3**

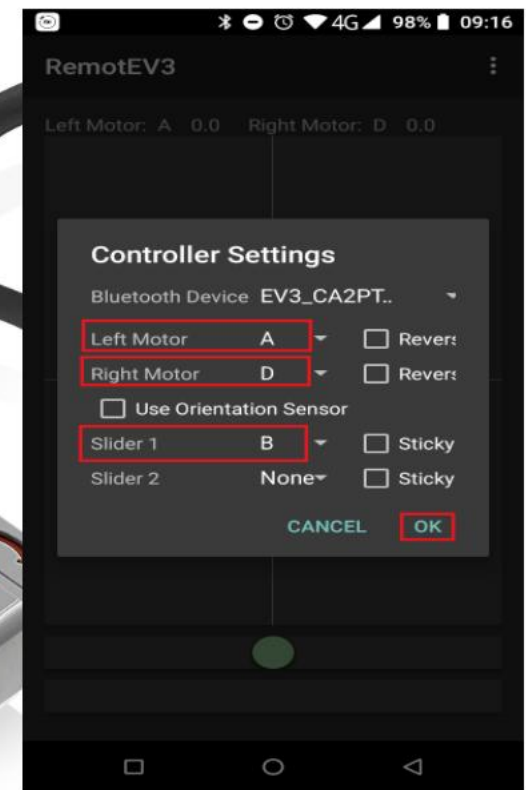

SETTINGS